



INSTALLER AND OWNER GUIDE

Please keep me in a safe place for future use.



Model Modena Homeflame Landscape

Inset live fuel effect gas fire

We trust that this guide gives sufficient details to enable this appliance to be installed, operated and maintained satisfactorily. However, if further information is required, our **Valor Technical Helpline** will be pleased to help.

Telephone **0844 879 35 88** (National call rates apply in the United Kingdom).

In the Republic of Ireland Telephone **01 842 8222**.



THIS APPLIANCE IS FOR USE WITH NATURAL GAS (G20).

THIS APPLIANCE IS SUITABLE ONLY FOR INSTALLATION IN THE UNITED KINGDOM (GB) AND THE REPUBLIC OF IRELAND (IE).

© GDC Group Ltd.

All rights reserved. No part of this publication may be reproduced in any material form (including photocopying), stored in any medium by electronic means (including in any retrieval system or database) or transmitted, in any form or by any means, whether electronic, mechanical, recording or otherwise, without the prior written permission of the copyright owner.

Applications for the copyright owner's permission to reproduce any part of this publication should be made, giving details of the proposed use, to the following address: The Marketing Communications Manager, GDC Group Ltd, Millbrook House, Grange Dive, Hedge End, Southampton, SO30 2DF.

Warning: Any person who does any unauthorised act in relation to a copyright work may be liable to criminal prosecution and civil claims for damages.

Because our policy is one of constant development and improvement, details may vary slightly from those given in this publication

Safety First.

Valor fires are CE Approved and designed to meet the appropriate British Standards and Safety Marks.



Quality and Excellence.

All Valor fires are manufactured to the highest standards of quality and excellence and are manufactured under a BS EN ISO 9001 quality system accepted by the British Standards Institute.



The Highest Standards

Valor is a member of the Benchmark scheme and HHIC (Heating and Hot water Industry Council) that work to ensure high standards of safety, quality and performance.



Careful Installation

This gas fire must be installed by a competent GAS SAFE REGISTER operative in accordance with this installer guide.



INSTALLER GUIDE

FOR OWNER GUIDE SEE PAGES 45 TO 64

INSTALLER GUIDE

CONTENTS

<u>Section</u>	<u>Page</u>
INSTALLER GUIDE	4 - 43
OWNER GUIDE	44 - 58
1. APPLIANCE DIMENSIONS	8
2. SAFETY	9
3. THE BENCHMARKING SCHEME	10
4. APPLIANCE DATA, EFFICIENCY AND NO_x	11
4.1 General information.	11
4.2 Efficiency.	12
4.3 NO _x	12
4.4 Accessories	12
5. GENERAL INSTALLATION REQUIREMENTS	13
5.1 Regulations, Standards and Law.	13
5.2 Ventilation requirements.	13
5.3 The Atmosphere sensing device (ASD).	14
5.4 Fireguard requirements.	14
5.5 Room considerations.	14
5.6 Chimney preparation.	14
5.7 Fireplace preparation.	14
5.8 The fireplace.	15
5.9 Fireplace clearances.	15
5.10 Installation options.	16 - 17
5.11 Flues.	17
6. PACK CONTENTS	18 - 19
7. FIREPLACE CHECK	20
7.1 Soundness for appliance attachment.	20
7.2 Fireplace flue pull.	23
8. GAS SUPPLY CONNECTION	20
9. PREPARING APPLIANCE FOR INSTALLATION	21 - 23
10. IGNITION CHECK	24
10.1 Fitting slider handle to control cam	24
10.2 Fitting the battery into spark ignition generator	24
10.3 Checking the ignition operation	24

Continued on next page

CONTENTS (Continued)

<u>Section</u>	<u>Page</u>
11. CONVECTION BOX INSTALLATION	25
11.1 Method 1 - Front fixing to fireplace surround.	25
11.2 Method 2 - Cable retention and floor fixing.	25 - 27
11.3 Sealing floor front	27
12. FITTING THE WALL LINERS & FUEL EFFECT	28
12.1 Fitting the wall liners (Vermiculite)	28
12.2 Fitting the side wall liners (Vermiculite/Ceramic/Glass.	28
12.3 Positioning the Ember wool	28
13. FITTING THE LOG FUEL EFFECT	29 - 31
14. BURNER AND SUPPLY PIPE INSTALLATION	32
14.1 Burner installation.	32
14.2 Supply pipe installation.	32
14.3 Burner checks.	32
- 14.3.1 Lighting the fire	32
- 14.3.2 Adjusting flame height	33
- 14.3.3 Turning off	33
14.4 Check inlet pressure.	33
15. REASSEMBLE OF FIRE	34
15.1 Fitting the bottom tray into convector box	34
15.2 Fitting the top tray into the convector box	34
15.3 Positioning the ember wool accross the burner	34
15.4 Replacing the log fuel effect	34
15.5 Refit the window door panel	34
15.5 Refit the visual baffle	34
16. FULL OPERATING CHECKS	35
16.1 Check the burner operation.	35
16.2 Check for spillage.	35
16.3 Flame supervision and spillage monitoring system.	36
17. TRIM INSTALLATION	36
18. FINAL REVIEW	37

Continued on next page

<u>Section</u>	<u>Page</u>
19. SERVICING & PARTS REPLACEMENT	38
19.1 To remove the trim.	39
19.2 To remove the visual baffle.	39
19.3 To remove the window door panel.	39
19.4 To remove the fuel effect and ember wool	39
19.5 To remove the top tray.	39
19.6 To remove the base tray.	39
19.7 To remove the burner assembly and tray	40
19.8 To access and remove the Inspection panel	40
19.9 Checking the aeration settings of the burner	40
19.10 To remove the wall liners	41
19.11 To remove the pilot unit.	41
19.12 To remove the Teddington gas valve and switch.	42
19.13 To replace the burner.	42
19.14 To remove the burner injector.	42
19.15 To remove the appliance from the fireplace.	43

INSTALLER GUIDE

1. APPLIANCE DIMENSIONS

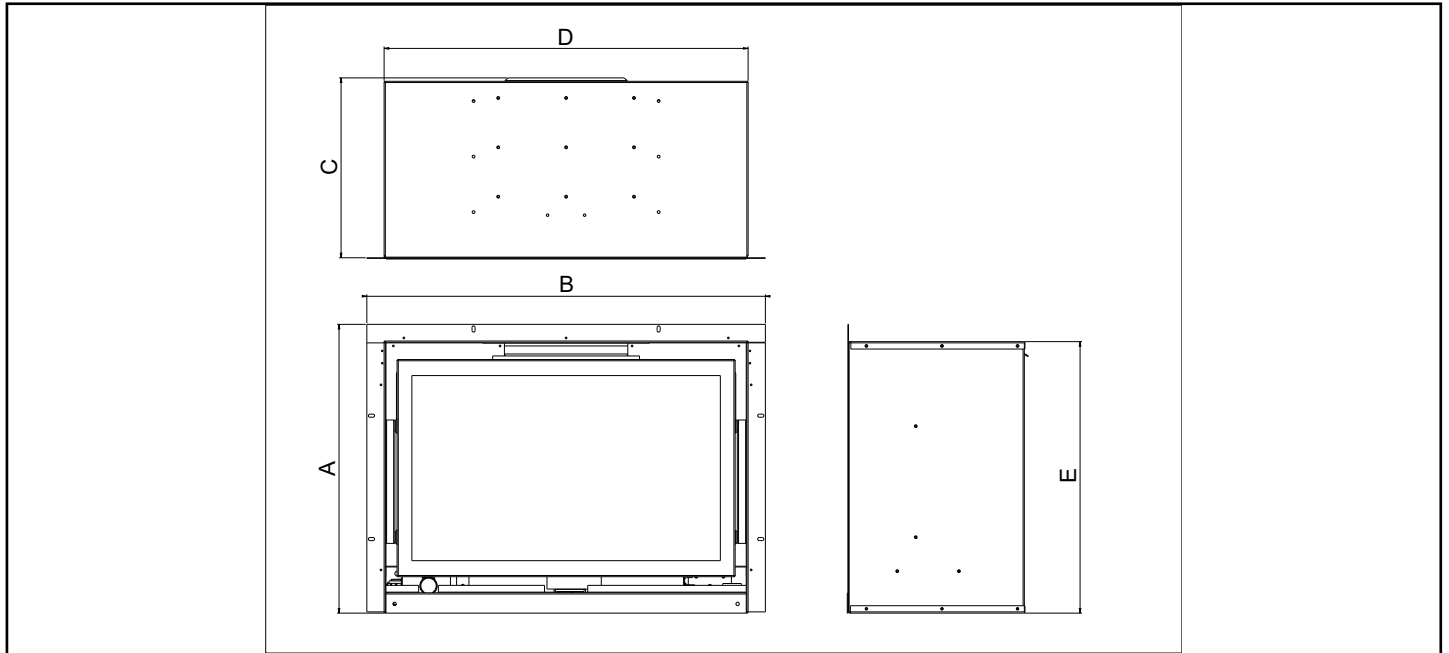

Dimension	Modenza
A	470 mm
B	646 mm
C	293 mm
D	596 mm
E	443 mm

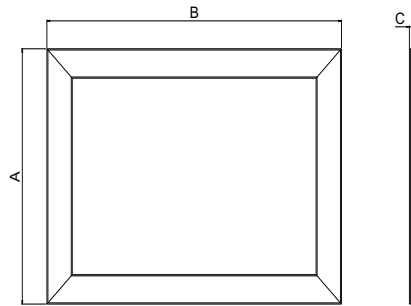

TRIM

Outside Dimensions stated.

Dimension	Trim
A	501 mm
B	677 mm
C	10 mm

Installer

Before continuing any further with the installation of this appliance please read the following guide to manual handling.

- The lifting weight of this appliance (kg) is approx as below:

<u>Model</u>	<u>Weight</u>
Modenza Homeflame engine only*	17 Kg

**excludes trim & ceramic log set.*

These appliances are heavy. We therefore recommend that two person's should be sufficient to lift the fire. If fitting or moving the fire alone we recommend the use of suitable lifting apparatus.

- When lifting always keep your back straight. Bend your legs and not your back.
- Avoid twisting at the waist. It is better to reposition your feet.
- Avoid upper body/top heavy bending. Do not lean forward or sideways whilst handling the fire.
- Always grip with the palm of the hand. Do not use the tips of fingers for support.
- Always keep the fire as close to the body as possible. This will minimise the cantilever action.
- Use gloves to provide additional grip.
- Always use assistance if required.
- **This product uses log fuel effect pieces, burner compartment walls and ceramic pebbles containing Refractory Ceramic Fibres (RCF), which are man-made vitreous silicate fibres. Excessive exposure to these materials may cause irritation to eyes, skin and respiratory tract. Consequently, it is important to take care when handling these articles to ensure that the release of dust is kept to a minimum. To ensure that the release of fibres from these RCF articles is kept to a minimum, during installation and servicing we recommend that you use a HEPA filtered vacuum to remove any dust and soot accumulated in and around the fire before and after working on the fire. When replacing these articles we recommend that the replaced items are not broken up, but are sealed within a heavy duty polythene bag, clearly labelled as RCF waste. RCF waste is classed as a stable, non-reactive hazardous waste and may be disposed at a landfill licensed to accept such waste. Protective clothing is not required when handling these articles, but we recommend you follow the normal hygiene rules of not smoking, eating or drinking in the work area and always wash your hands before eating or drinking.**
- This appliance does not contain any component manufactured from asbestos or asbestos related products.

GDC Group is a licensed member of the Benchmark Scheme which aims to improve the standards of installation and commissioning of domestic heating and hot water systems in the UK and to encourage regular servicing to optimise safety, efficiency and performance. Benchmark is managed and promoted by the Heating and Hotwater Industry Council.

It places responsibilities on both manufacturers and installers. The purpose is to ensure that customers are provided with the correct equipment for their needs, that it is installed, commissioned and serviced in accordance with the manufacturer's instructions by competent persons and that it meets the requirements of the appropriate Building Regulations.

The Benchmark Checklist (on the inside back pages of this guide) can be used to demonstrate compliance with Building Regulations and should be provided to the customer for future reference.

Installers are required to carry out installation, commissioning and servicing work in accordance with the Benchmark Code of Practice which is available from the Heating and Hotwater Industry Council who manage and promote the Scheme. Visit www.centralheating.co.uk for more information.

At the time of commissioning, complete all relevant sections of the Benchmark Checklist located on the inside back pages of this document.



INSTALLER GUIDE

4. APPLIANCE DATA, EFFICIENCY, NO_x AND Accessories

4.1 General information.

The appliance information label is located on the burner tray on the left hand side of the fire. This can be found by removing the Visual Baffle and Trim if fitted.

Model	Modenza
Gas	Natural (G20)
Input - Max (Gross)	5.6kW (19,108 Btu/hr)
Input - Med (Gross)	3.7kW (12,625 Btu/hr)
Input - Min (Gross)	2.7kW (9,213 Btu/hr)
Inlet Test Pressure (Cold)	20.0 +/- 1.0 mbar (8.0 +/- 0.4in w.g.)
Gas Connection	8mm pipe
Burner Injector	Cat 82 - Size 65
Pilot & Atmosphere Sensing Device	NG9093
Ignition	Electronic (Mounted on gas valve)

INSTALLER GUIDE

4.2 Efficiency.

The efficiency of this appliance has been measured as specified in BS 7977 - 1 and the results are as below :

<u>Model</u>	<u>Efficiency % (Gross)</u>	<u>Efficiency % (Net)</u>
Modenza Homeflame	68%	75%

The gross calorific value of the fuel has been used for this efficiency calculation.

Gas	Conversion factor from net to gross efficiency
Natural Gas	0.901

The conversion of **net** efficiency to **gross** was achieved by multiplying the net efficiency by the following conversion factor from Table E3 of SAP 2005, rounding down to the nearest whole number.

4.3 NO_x

For NG the 'Weighted' result for these appliances equates to NO_x Class 4.

4.4 Accessories

Gather Hood Connector Inspire 600FS/600RC Product Code: **061638**
and Modena

5.1 Regulations, Standards and Law.

The installation must be in accordance with these instructions.

For the user's protection, in the United Kingdom it is the law that all gas appliances are installed by competent persons in accordance with the current edition of the Gas Safety (Installation and Use) Regulations. Failure to install the appliance correctly could lead to prosecution. GAS SAFE REGISTER require their members to work to recognised standards.

In the United Kingdom the installation must also be in accordance with:

All the relevant parts of local regulations.

All relevant codes of practice.

The relevant parts of the current editions of the following British Standards:-

BS EN 1856 Part 1 Chimneys - Requirements for metal chimneys.

BS 5440 Part 1 Installation of flues.

BS 5440 Part 2 Installation and maintenance of flues and ventilation for gas appliances of rated input not exceeding 70 kw net (1st, 2nd and 3rd family gases).

BS 6461 Part 1 Masonry chimney & flues - Installation.

BS 1251 Fireplace components.

BS 5871 Part 2 Installation - Inset LFE gas fires.

BS 6891 Gas pipework installation.

- In England and Wales, the current edition of the Building Regulations issued by the Department of the Environment and the Welsh Office.
- In Scotland, the current edition of the Building Standards (Scotland) Regulations issued by the Scottish Executive.
- In Northern Ireland, the current edition of the Building regulations (Northern Ireland) issued by the Department of the Environment for Northern Ireland.
- In the Republic of Ireland the installation must be carried out by a competent person and also conform to the relevant parts of:
 - a) The current edition of IS 813 "Domestic Gas Installations"
 - b) All relevant national and local rules in force.

Where no specific instructions are given, reference should be made to the relevant British Standard Code of Practice.

5.2 Ventilation requirements.

Normal adventitious ventilation is usually sufficient to satisfy the ventilation requirements of this appliance. In GB reference should be made to BS 5871 Part 2 and in IE reference should be made to the current edition of IS 813 "Domestic Gas Installations" which makes clear the conditions that must be met to demonstrate that sufficient ventilation is available.

5.3 The Atmosphere sensing device (ASD).

The appliance is fitted with an A.S.D (Atmosphere sensing device). If the appliance closes down after a period of operation for no apparent reason, the consumer should be informed to stop using the appliance until the installation and appliance have been thoroughly checked. The A.S.D will shut the appliance down if an unacceptable amount of harmful products of combustion accumulate. Under no circumstances should the A.S.D be altered or bypassed in any way. Only a genuine manufacturer's replacement part should be fitted. The individual A.S.D components are not replaceable.

5.4 Fireguard requirements.

A fireguard complying with BS 8423 should be fitted for the protection of young children, the elderly, the infirm and pet animals.

5.5 Room considerations.

5.5.1 This appliance must not be installed in any room that contains a bath or shower or where steam is regularly present.

5.5.2 An extractor fan may only be used in the same room as this appliance, or in any area from which ventilation for the appliance is taken, if it does not affect the safe performance of the appliance. Note the spillage test requirements detailed further on in this manual. If the fan is likely to affect the appliance, the appliance must not be installed unless the fan is permanently disconnected.

5.5.3 Do not place any flammable materials within a distance of 0.5 m of the radiation of the appliance and ventilation grills.

5.6 Chimney preparation.

5.6.1 If the appliance is intended to be installed to a chimney that was previously used for solid fuel, the flue must be swept clean prior to installation. All flues should be inspected for soundness and freedom from blockages.

5.6.2 Any chimney damper or restrictor should be removed. If removal is not possible, they must be secured in the open position.

5.7 Fireplace preparation.

5.7.1 If the fireplace opening is an underfloor draught type, it must be sealed to stop any draughts.

5.7.2 The fireplace floor should be reasonably flat to ensure that the convection box can be installed without it rocking and so that a good seal can be made at the bottom front of the box.

5.7.3 The front face of the fireplace should be reasonably flat over the area covered by the convection box top and side flange seals to ensure good sealing. These faces should be made good if necessary.

INSTALLER GUIDE

5.7.4 Like all efficient gas fires care should be taken to the choice and layout of installed back panels. Marble and other similar natural materials may have microscopic flaws or stress points, under heat these may open and crack. If in doubt the use of a three/four piece back panel layout is recommended.

5.8 The fireplace.

The appliance can be fitted to a purpose made proprietary class “O”-150°C surround. The hearth material must be at least 12mm thick. The periphery of the hearth (or fender) should be at least 50mm above floor level to discourage the placing of carpets or rugs over it.

The surface of the hearth must be sufficiently flat to enable the bottom of the front surround and the bottom front cover to be aligned horizontally. Any excessive unevenness (uneven tiles, Cotswold stone, etc.) should be rectified.

The appliance must not stand on combustible materials or carpets. Where no hearth is fitted.

5.9 Fireplace clearances.

5.9.1 DO NOT install onto a combustible wall; all combustible materials must be removed from the area shown in below diagram. The use of heat resistant plaster or board is recommended within the below shaded areas.

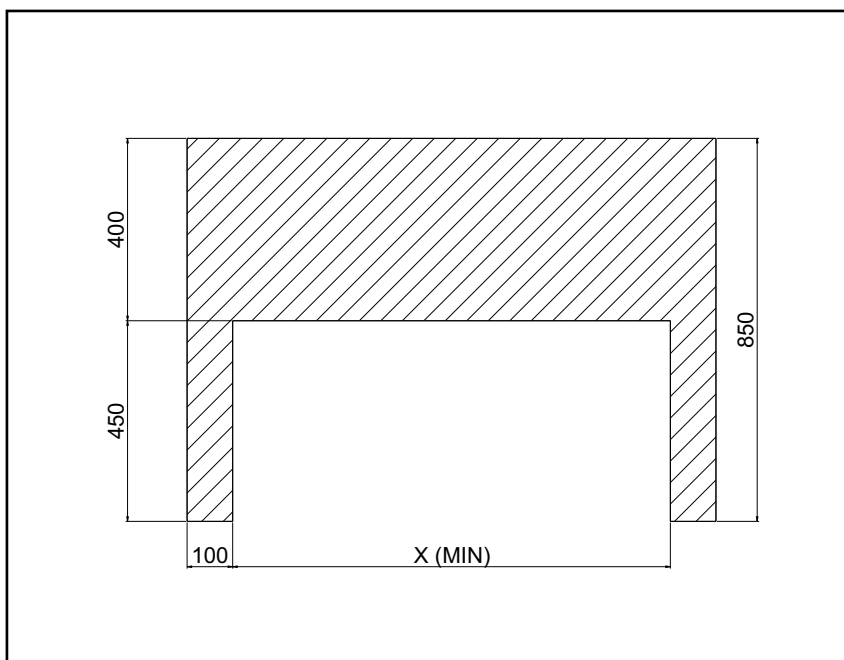

Model	Dimension X
Modenza	600 mm Min

5.9.2 A combustable shelf must be a minimum of 400mm above the top of the appliance. This is based on a 150mm deep shelf. For every extra 13mm of depth add 25mm above the 400mm from the top of the appliance, not the trim.

5.9.3 A side wall must be a minimum of 300mm from the side of the appliance, not the trim.

5.10 Installation options.

In the United Kingdom, as supplied, the appliance can be installed in the following situations:

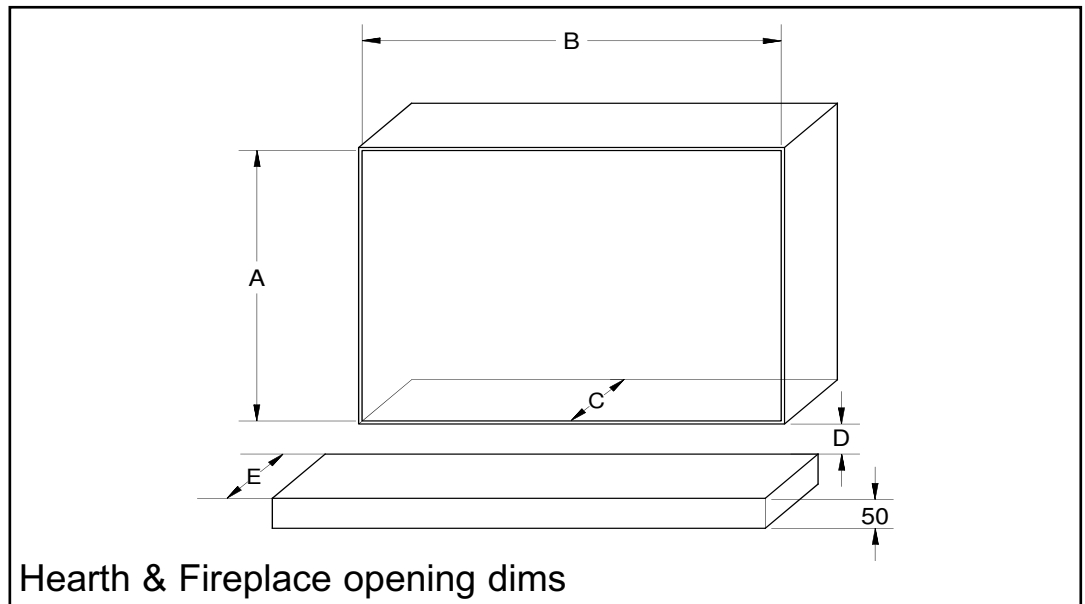

Dimension	Modenza
A	460 mm Max / 450 mm Min
B	635 mm Max / 600 mm Min
C	340 mm Min
D (Trim)	25 mm Min
E	300 mm Min

Note: “D” dimension critical for clearance of the trim depth

5.10.1 Conventional fireplace and hearth.-

To a fireplace opening and hearth complying with BS1251 after removal of the fireback and sufficient material behind the fireback for a debris catchment space.

5.10.2. ‘Hole-in-the-wall’ Installations

- It is recommended that a hearth should be installed as in section 5.8.
- If a hearth is not fitted, the fire must be installed so that the distance from the base of the fireplace opening in the wall to the finished floor level is at least 110mm. Where there is no floor covering or carpet and the floor is of a type that is likely to be covered in such a way in the future then the distance from the base of the fireplace opening in the wall to the floor level should be increased to at least 180mm.

5.10.3. Gather hood installation in Stud work Chimney

The Inspire gas fire products are intended to be used only in a fireplace of non-

combustible material. However if a stud work chimney breast is used the builder/installer **MUST** ensure to leave a minimum **75mm** clear to the sides of the appliance and a minimum of **100mm** clear to the rear of the gather hood connector.

Directly above the appliance the area should be left clear to prevent a build-up of heat. If the fireplace wall ends at ceiling height two air vents of at least 50cm² should be installed one at the bottom and one at the top of the wall to reduce heat build-up.

Note: There are three suitable Convectional Flue Options;

1. Rear exit - Builders opening Unlined 178mm (7") minimum.
2. Top Exit - Builders opening Lined 127mm (5")
3. Stud work is Top Exit only - Twin Wall Rigid 127mm (5")

5.11 Flues.

1. Suitable flues and minimum flue sizes are as follows: -

It should be noted that, as with many appliances, sharp bends or horizontal runs in metal flues at the top of the system can be a cause of problems in these types of installation.

- 225mm x 225mm conventional brick flue.
- 125mm and 175mm diameter lined brick or stone flue.
- 200mm diameter factory made insulated flue manufactured to BS4543 Part 2.
- 175mm diameter flue pipe. See BS6461 Part 1 for suitable materials.
- Single wall, twin wall or flexible flue liner with a minimum diameter of 125mm. The materials to be used are stainless steel or aluminium as specified in BS EN 1856 Part 1. The liner must be sealed to the surrounding area above the fireplace opening and to the top of the chimney. An approved terminal must be fitted.

2. The flue must conform to BS 5440: Part 1 in design and installation.

The flue, measured from the bottom of the fireplace opening to the bottom of the terminal, shall be not less than 3m in actual vertical height. When calculated in accordance with BS 5440: Part 1 Annex A, the minimum equivalent height of the flue shall be 2.0m of 125mm dia. flue pipe.

3. The flue must not be used for any other appliance or application.

4. Proprietary terminals must comply with BS 715 or BS 1289. Any terminal or termination must be positioned in accordance with BS 5440 Part 1 to ensure that the products of combustion can be safely dispersed into the outside atmosphere. Where the appliance is connected to an unlined brick chimney it is generally unnecessary for the chimney pot to be replaced or for a terminal to be fitted unless the flue has a diameter smaller than 170mm.

INSTALLER GUIDE

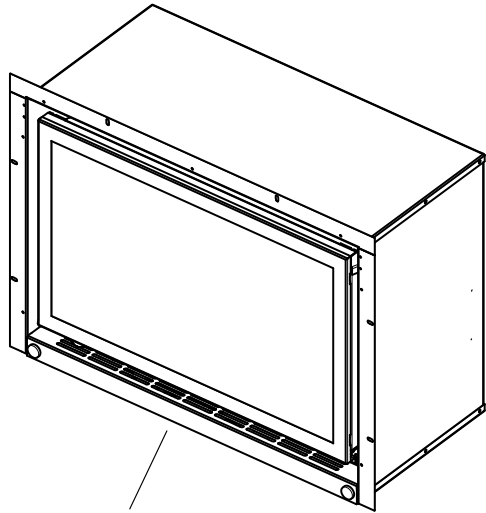

Burner and Convector box unit (1 off)

Fire retaining cables (2 off)

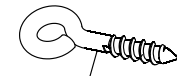
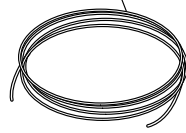

Eyebolt (4 off)

Fibre / wooden plugs (10 off)

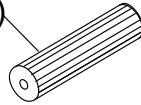

Cable clamp (2 off)

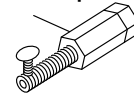

Nut and Olive (1 off)



Inlet 'T' Connector (1 off)

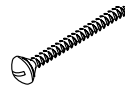
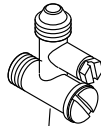

Wood screw (6 off)

Smoke match tube (1 off)

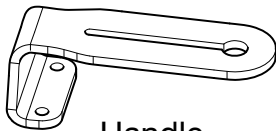
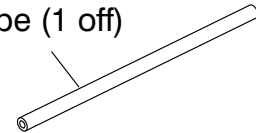

Handle (1 off)



M4 x 8 machine screws to secure slider handle (2 off)

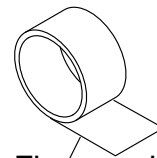

Floor sealing tape (2 off)

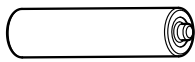

AA Battery (1 off)

Back Wall Liner (2 pieces)

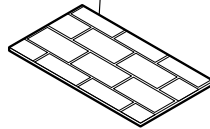

Jiffy bag of Ember wool (1 off)

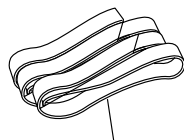

Long length of foam seal (1 off)

Side Walls Liners (2 off)

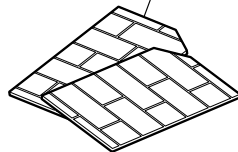

NOTE: For illustration only
Liner style will vary

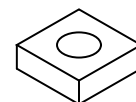

Magnets to secure the Trims (4 off)

INSTALLER GUIDE

6. PACK CONTENTS

The items required for this appliance are packed in sections.

NOTE: The Vermiculite liner set is fragile so care is necessary when handling. They are packed inside the top fitment as you open the carton.

Section 1 - Fire unit contains:

- 1 Burner and convection box unit.
- 1 Dark Oak - Log fuel effect set
- 1 Literature pack

Section 2 - Accessory box contains:

- 1 Vermiculite Wall liners set (2 sides and 2 rear pieces)
- 1 Self adhesive foam seal
- 6 Wood screws
- 10 Wood Wall plugs
- 2 Cable clamps
- 2 Fire retaining cables
- 4 Eyebolts
- 2 Floor sealing tape
- 1 'T' connector and pressure test point.
- 1 Nut and olive for 8mm inlet pipe.
- 1 Smoke match tube
- 1 Ember wool (approx 0.5 g)
- 1 Black slider handle
- 2 M4 x 8 machine screws (to secure the Slider handle)
- 1 Alkaline 'AA' Battery

Section 3 - Trim pack contains:

- 1 Trim.
- 4 Square magnets (Used to secure Trim onto engine)

Carefully remove all the contents. Take special care in handling the ceramic pieces. Check that all the listed parts are present and in good condition.

INSTALLER GUIDE

7. FIREPLACE CHECK

7.1 Soundness for appliance attachment

Primary method of retaining the appliance is by fixing to the fireplace front.

The methods are detailed in section 11 of this manual. Before selecting the retention method, consult with the customer.

Method 2 is provided for instances where drilling holes in the front surface of the fireplace surround is unacceptable to the customer or otherwise impractical. *N.B. It is unwise to attempt to drill into marble without the proper tools and equipment.*

If method 1 is chosen, make sure that the front surround area is sound enough to take the wall plugs and wood screws. If necessary, make sound with suitable cement. If method 2 is chosen, make sure that the areas at the back and towards the centre of the fireplace floor are sound enough to take the eyebolts and screws. If these areas have deteriorated due to prolonged use, they should be made sound with suitable cement.

7.2 Fireplace flue pull.

Close all doors and windows in the room in which the appliance is to be installed.

After confirming with a match that smoke is drawn into the flue, light a 13 gram smoke pellet and check that there is a definite flow through the flue. Verify outside that the smoke exits from one terminal only and that the termination is suitable.

Observe where possible, upstairs rooms and loft spaces for signs of escaping smoke indicating a defective flue. If there is not a definite flow warm the flue for a few minutes and repeat the smoke pellet test. If there is still no definite flow the flue may need remedial work – **Do not fit the appliance until there is a definite flow through the flue.**

8. GAS SUPPLY CONNECTION

The fire is designed for a rear concealed connection only.

A nut and olive are provided for an 8mm pipe inlet connection to the 'T' connector at the bottom front of the appliance. The 'T' connector can be rotated to allow connection and includes a valve for isolating the gas supply and a pressure test point. The supply pipe must be rigid material. Flexible pipe must not be used.

Before the appliance is fitted into the fireplace it will be necessary to extend the supply line so that it will project through the hole in the back of the convection box and run to the 'T' connector at the front. The pipe run from the supply line up to the rear opening in the convection box must be kept away from the area which will be taken by the convection box when it is installed.

INSTALLER GUIDE

9. PREPARING APPLIANCE FOR INSTALLATION

9.1. Remove the visual baffle, by unscrewing by hand the two M5 knurled screws in an anti clockwise direction. Keep these two screws save as they will be needed later. Carefully slide out the visual baffle and place carefully to one side.

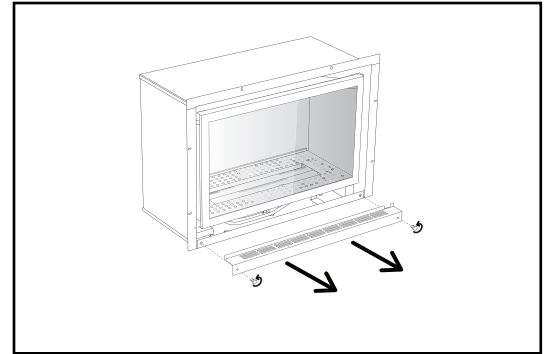

9.2. Remove the glass door, by unscrewing by hand the two M5 knurled screws in an anti clockwise direction located just under the base of the door frame. Keep these two screws save as they will be needed later. Carefully lift out at the base then up and away from the convection box. Place carefully to one side.

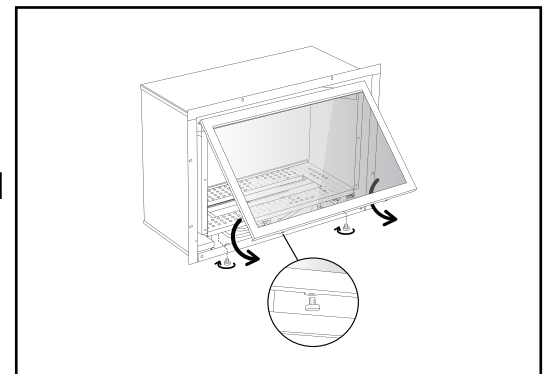

9.3. Remove the Log set box and carefully place to one side.

9.4. Lift up and out the Top tray and carefully place to one side. There are no screws holding this tray in place.

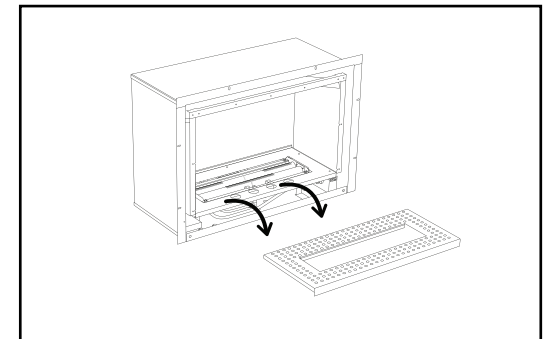

9.5. Unscrew the base tray, then remove by lifting up and out. Place to one side carefully.

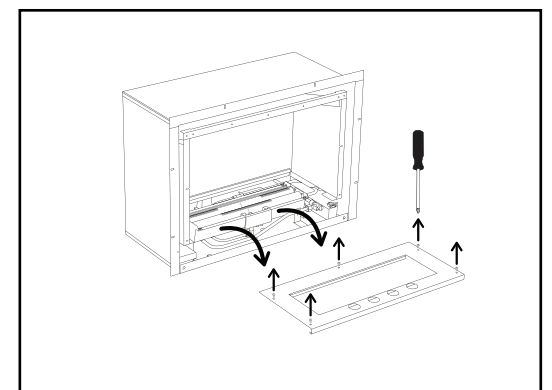

INSTALLER GUIDE

9.6. Detach the burner tray from the convection box by removing two locating screws. Slide the burner tray forward and clear of the convection box.

IMPORTANT

Before continuing with the installation of this gas fire the Aeration Setting on the burner must be checked. The aeration is factory set and should not require adjustment.

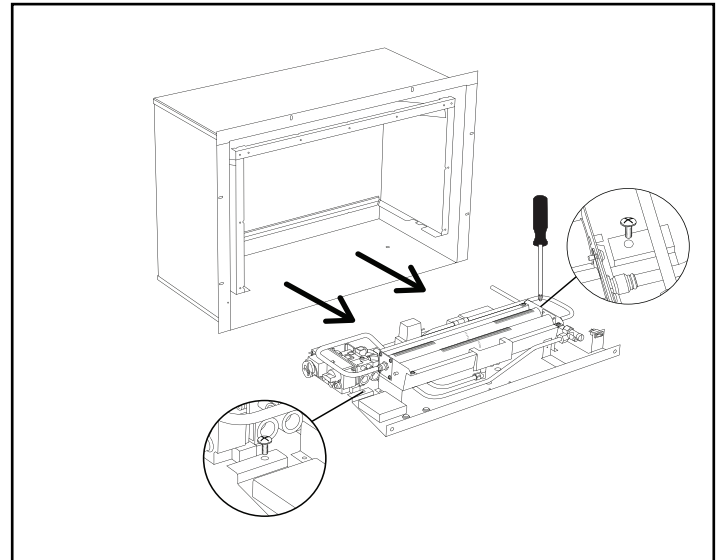

9.7. It is important that the inlet cover plate supplied in the Accessory parts pack is fitted to cover the entry hole in the inside rear of the convection box. The inlet cover plate has a slot to allow the pipe to pass through its center. The slot is larger than the 8mm pipe so the remaining open area **MUST** be sealed with tape after the pipe is located.

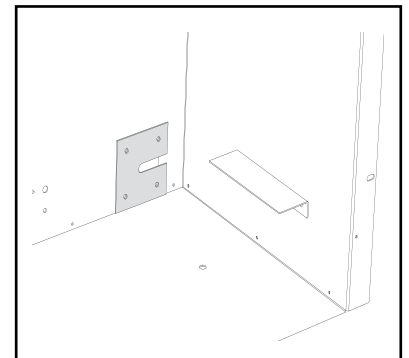

9.8. This appliance is supplied with a **flue restrictor** this is for use where the flue draught is excessive. There may however, be certain circumstances where closing the restrictor causes the fire to fail the spillage test. In such cases the restrictor will have to be returned to its supplied state of fully open. After any changes conduct the spillage check again. The restrictor is prefitted (fully open) to the inside rear of the convector box, if necessary loosen the three screws and slide upwards. The restrictor has a limited travel so the outlet cannot be fully closed.

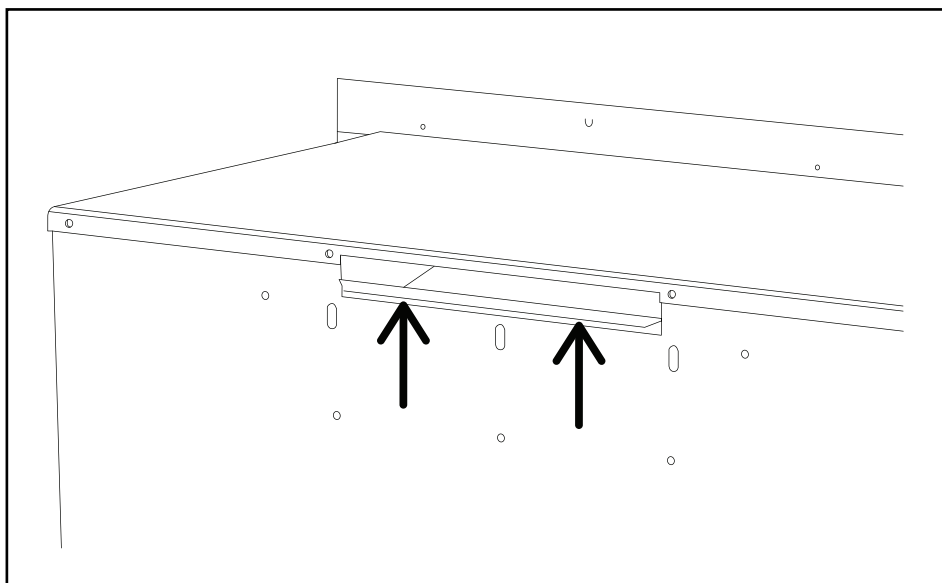

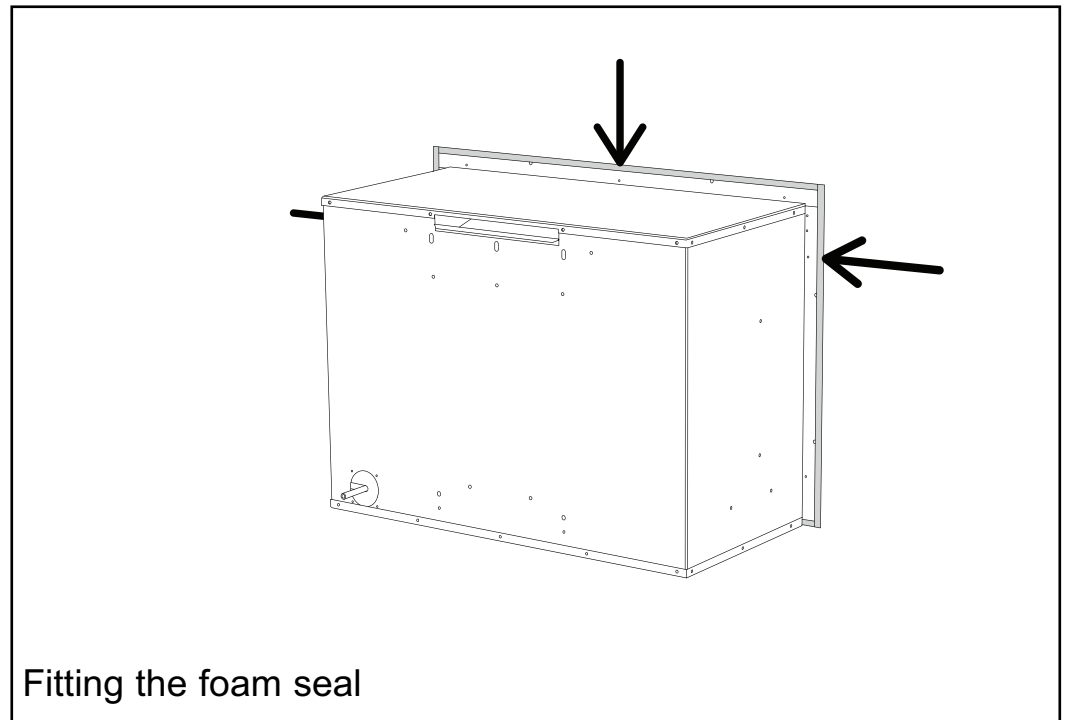

9.9. There is a length of self adhesive foam seal supplied with the fire. This will need to be fitted to the outer rear edges of the side and top flanges of the convector box. **Ensure that there is no gap between the foam seals where they meet.** It is important that the bottom of the side flanges are sealed.

Before attempting to install, it is worth checking that the ignition system performs satisfactorily.

Slider Control

10.1 Fitting slider handle to control cam.

The slider handle needs to be fitted to the cam assembly as shown, with the two M4 x 8mm screws provided.

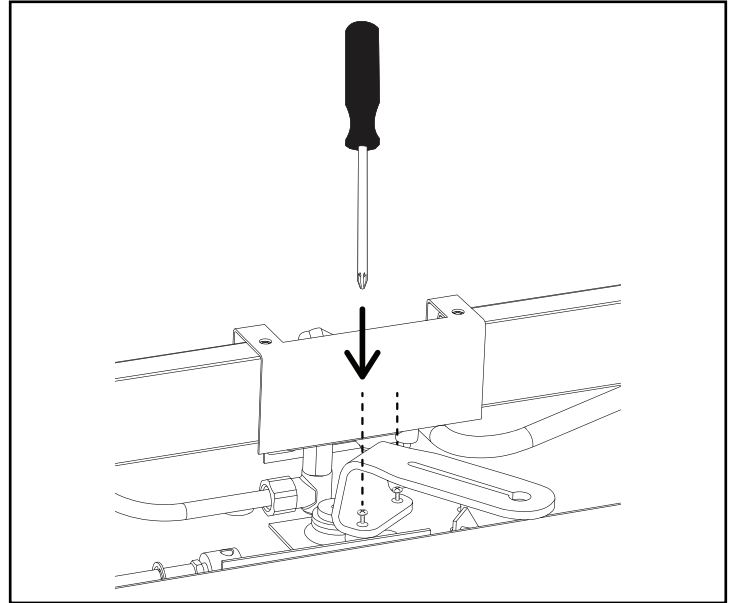

10.2 Fitting the battery into the spark ignition generator.

At the front of the electronic spark generator there is a removable circular battery cover. Unscrew the cover in an anticlockwise direction.

Remove any protective film from the battery if applicable and place into the generator. The negative (-) terminal should go in first. The battery is marked with (+).

Screw back on the cap.

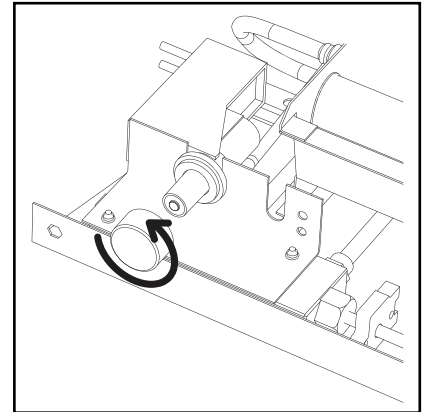

10.3 Checking the ignition operation.

– Push the slider handle to the LEFT as far as possible till the ignition is visible, several sparks should be generated and heard between the electrode and pilot tip.

– If there are no sparks check the following:

– Ensure that the electrode lead is connected to the terminal at the base of the electrode.

– If the above is correct, check for damage to the electrode lead and that the battery has been correctly fitted.

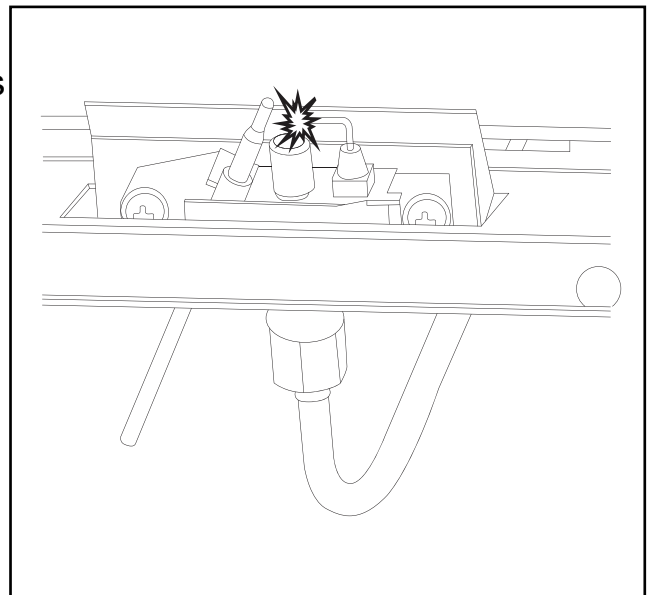

11. CONVECTION BOX INSTALLATION

11.1 Method 1 - Front fixing to fireplace surround.

1. Make sure that the fireplace front surround area is sound enough to take the wall plugs and screws. If necessary, make sound with suitable cement.

2. Place the convection box centrally in the fireplace in the position in which it is to be permanently installed. Insert the convection box into the fireplace feeding the supply pipe through the drilled hole in the inside rear fitted cover plate.

3. Mark the fireplace front surround through the six fixing holes in the side flanges of the convection box.

4. Remove the convection box. Drill holes in the fireplace front surround at the marked positions using a suitably sized masonry drill for the wall plugs supplied.

5. Insert a wall plug into each hole.

6. Place the convection box back in position in the fireplace.

7. Fit a wood screw through each hole in the convection box flanges and tighten to seal the box to the fireplace surround.

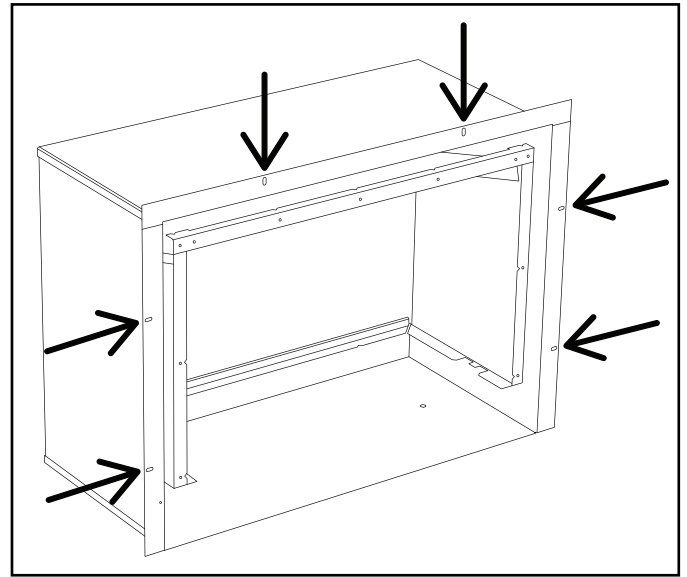

11.2 Method 2 - Cable retention.

1. Make sure that the relevant areas at the fireplace back are sound enough to take the eyebolts and screws. If this area have deteriorated due to prolonged use it should be made sound with suitable cement.

2. Drill four holes in the rear wall of the fireplace for the wall plugs. The holes should be drilled within the range of positions shown, using a suitably sized

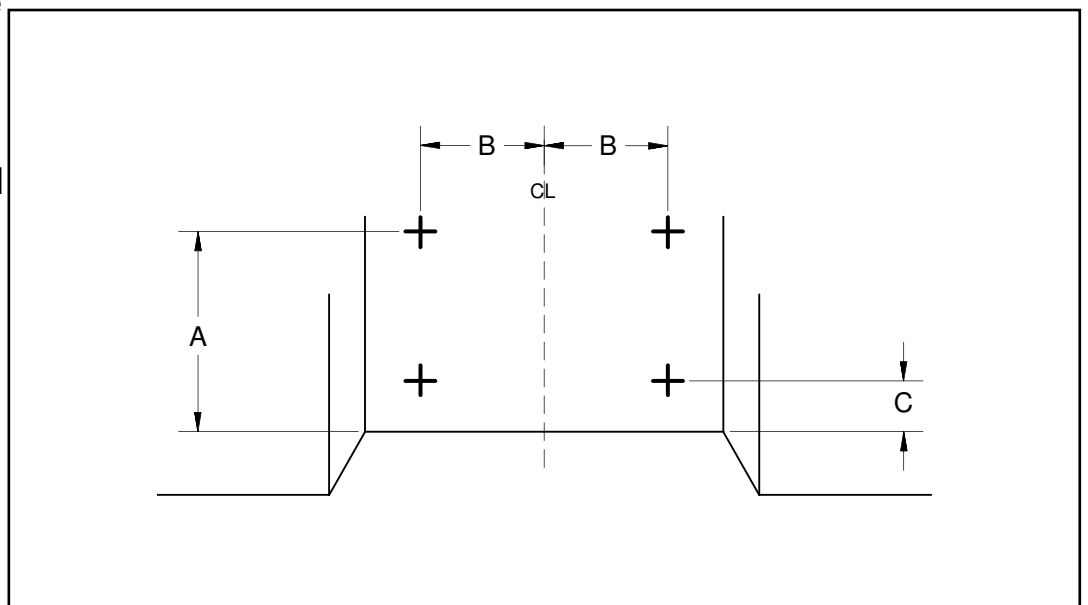

Dimension	Modenza
A	400 mm +/-10mm
B	200 mm +/- 10mm
C	55 mm +/- 10mm

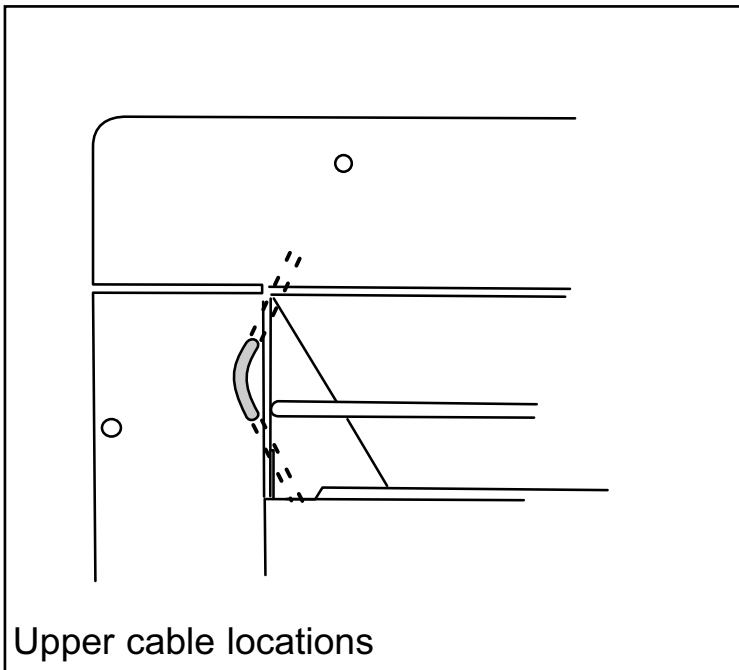

masonry drill for the wall plugs supplied. The holes should be equidistant each side of the centre line of the fireplace to ensure that the appliance finishes centrally in the opening when tension is applied to the cables.

3. Insert a wall plug into each hole. Use the wall plugs supplied with this appliance - **Never use plastic plugs instead of the wood wall plugs supplied.** Screw the eyebolts into the plugs. Make sure that the bolts are secure.

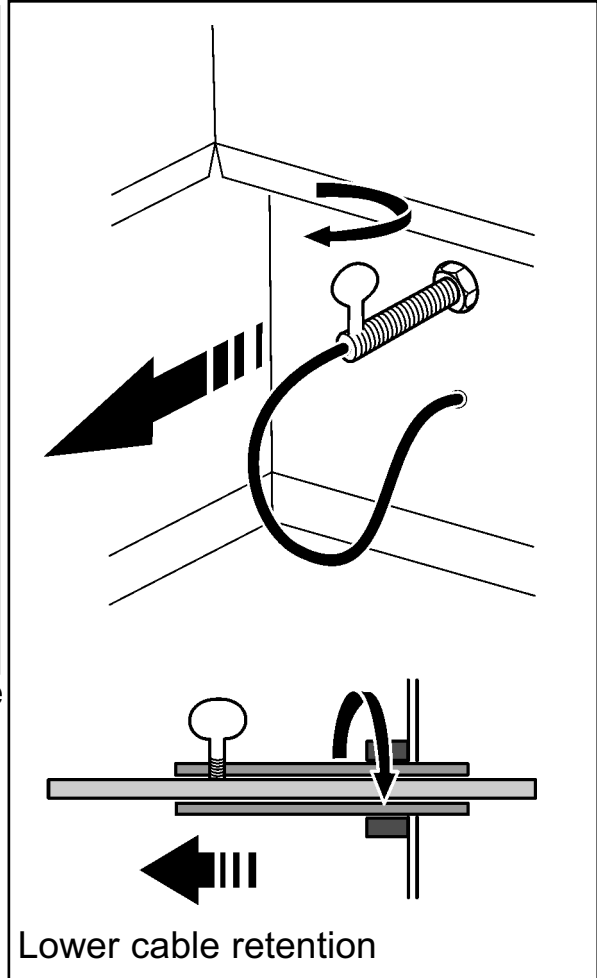

4. Place the convection box fully back into the fireplace opening so that it is sealed against the fireplace front surround.

Always screw the base into position before applying tension to the cables. This will ensure a tight seal between the top of the convection box and wall.

5. The convection box has two slots at each side of the flue outlet. Loop one end of each cable and pass the loop into the slots as shown. Give the cables a pull so that they grip.

6. Place the convection box unit close to the fireplace but allow sufficient access into the fireplace opening so that the cables can be threaded through the eyebolts and returned through the back of the convection box. If a concealed connection is being

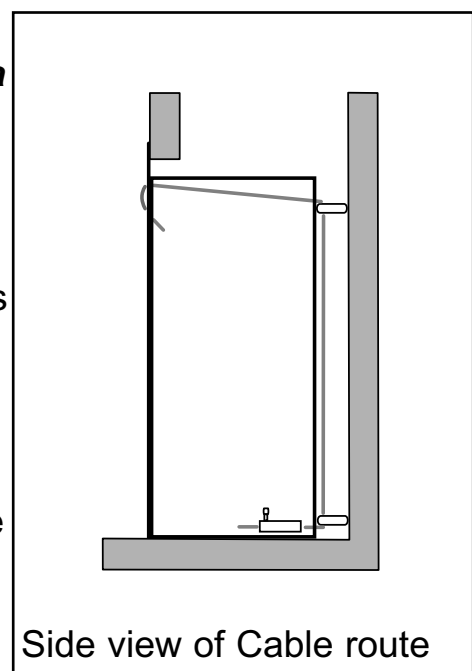

INSTALLER GUIDE

used, insert the convection box into the fireplace feeding the supply pipe through the pierced hole in the rear grommet.

7. Thread the cables through the eyebolts. Return the cables through the holes near the bottom of the convection box back panel.

8. Fit a cable retainer over the bottom end of each cable.

9. Pull each cable taut. Push the cable retainers hard up against the back panel. The end of the cable adjuster will pass into the hole. Tighten the screws in the retainers so that they clamp the cables in position. Apply tension to the cables by turning the hexagonal adjusters by hand.

10. Inspect the installation of the convection box against the fireplace surround. If the convection box is aligned squarely and the sealing is satisfactory, fully tighten the cable retainers.

11. If the convection box is not correctly aligned, release the tension on the cables by slackening the screws and turning the hexagonal adjusters fully anticlockwise. The convection box should then automatically realign itself. Pull each cable taut again and push the cable retainers back against the back panel. Again, tighten the screws in the retainers and apply tension to the cables by turning the hexagonal adjusters clockwise as far as possible.

12. Feed the free length of the cables through the small holes in the back of the convection box immediately below the cable adjusters so that they are available to allow easy removal and refitting of the appliance during subsequent service calls.

Do not cut off the free lengths of cable.

11.3 Sealing floor front and holes

Using the floor sealing tape supplied, seal the bottom of the convection box to the fireplace and hearth floor.

Make sure that the whole length of the front edge of the convection box is fully sealed.

A second strip of floor sealing tape is supplied. Use this to seal any small holes that remain at the lower rear and sides of the convection box.

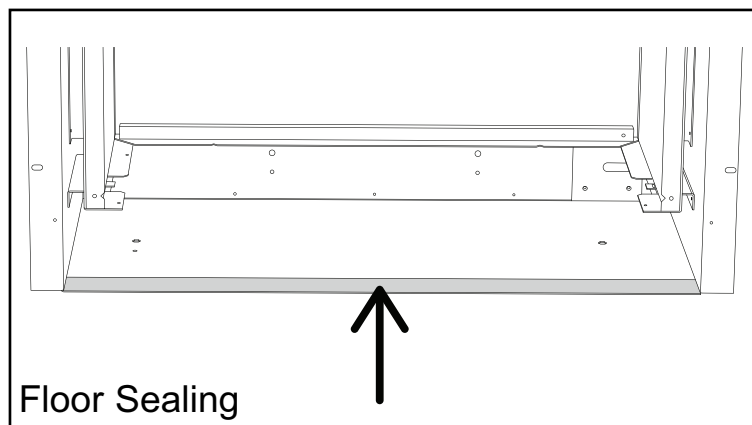

12. FITTING THE WALL LINERS & EMBER WOOL

12.1 Fitting the 2 piece rear wall liner. (Vermiculite)

The rear wall liners come as a two piece. Locate each rear ceramic wall against the rear wall of the convector box. Please note that when fitting this liner into the convector box it should be angled first on the flat to fit inside the inner convector box then gently raised to locate into the rear wall section.

Fit each piece side to side leaving no gaps.

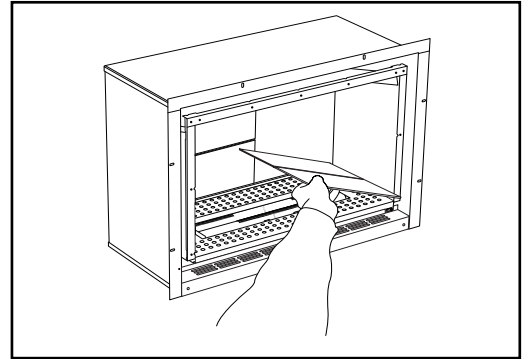

PLEASE NOTE: Care must be taken to avoid damage to the liners when fitting.

12.2 Fitting the side wall liners. (Vermiculite)

Offer the side wall liners into the convection box. The top of the ceramic side walls should be located first. With the top in place gently slide the side wall until it is flat against the side of the convection box. There is a soft bend metal tab at the base of the side liner this can be bent up at 90 degrees to secure the walls in place.

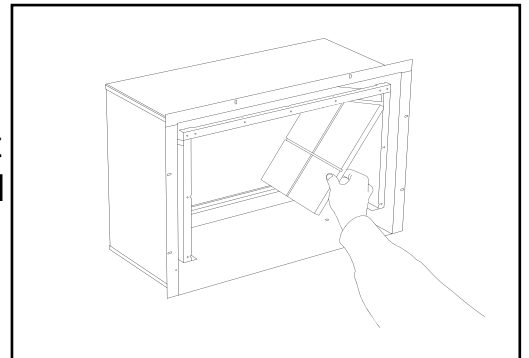

12.3 Positioning the ember wool across the burner.

The fire is supplied with a single bag of ember wool (approx. 0.5 gram).

DO NOT EXCEED THE WEIGHT OF EMBER WOOL SUPPLIED.

To ensure a good effect and so as not to effect combustion this ember wool must be placed as follows. The ember wool should be removed from the jiffy bag and teased apart until they form a very loose, very light network avoid clumps of ember wool in anyone section.

ONLY place the ember wool over the open burner ports. The ember wool has a long life, it will eventually deteriorate. If this becomes apparent, replacement ember wool can be obtained by calling our customer service team.

NOTE: to avoid any ignition interference issues, keep the ember wool at least **10mm** clear of the pilot unit when positioning.

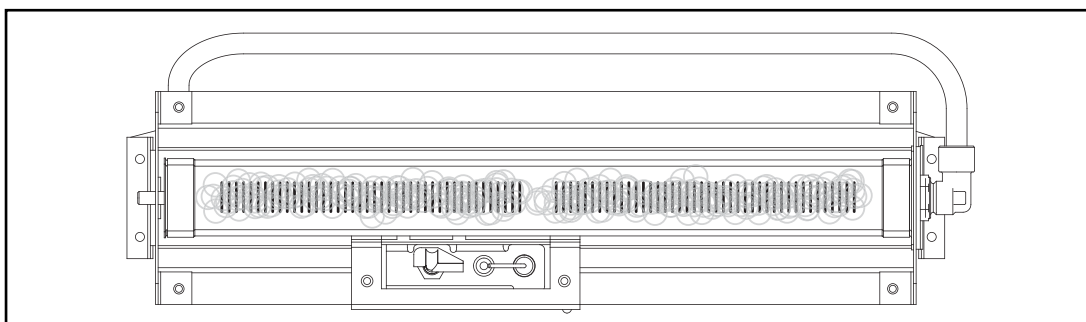

13. FITTING THE FUEL EFFECT

The detail hand painted on the ceramic fuel effect may be slightly different to that shown in the following illustrations.

SAFETY

This product uses fuel effect pieces containing Refractory Ceramic Fibres (RCF), which are man-made vitreous silicate fibres. Excessive exposure to these materials may cause irritation to eyes, skin and respiratory tract. Consequently, it is important to take care when handling these articles to ensure that the release of dust is kept to a minimum.

To ensure that the release of fibres from these RCF articles is kept to a minimum, during installation and servicing we recommend that you use a HEPA filtered vacuum to remove any dust and soot accumulated in and around the fire before and after working on the fire.

When replacing these articles we recommend that the replaced items are not broken up, but are sealed within a heavy duty polythene bag, clearly labelled as RCF waste. RCF waste is classed as a stable, non-reactive hazardous waste and may be disposed at a landfill licenced to accept such waste. Protective clothing is not required when handling these articles, but we recommend you follow the normal hygiene rules of not smoking, eating or drinking in the work area and always wash your hands before eating or drinking.

This appliance does not contain any component manufactured from asbestos or asbestos related products.

NOTE: The ceramic fuel effect may cause staining / discolouration to decorative surfaces. It is therefore advisable to protect decorative surfaces.

13.1. Place the LHS rear Matrix ceramic log '1' in position as shown opposite.

Note: It is important that this rear log is positioned correctly and does not cover the burner ports in any way.



13.2. Place the RHS rear Matrix ceramic log '2' in position as shown opposite. This ceramic log should locate into the step in log '1'.

Note: It is important that this rear log is positioned correctly and does not cover the burner ports in any way.



13.3. Place log '3' as shown opposite, resting the back of the log onto Log '2'.



13.4. Place log '4' to the left of log '3' so that it is resting flat along the front as shown opposite.

Note: It is important that this log is positioned correctly and does not cover the burner ports in any way.



13.5. Place log '5' as shown opposite, resting the back of the log onto Log '1'.

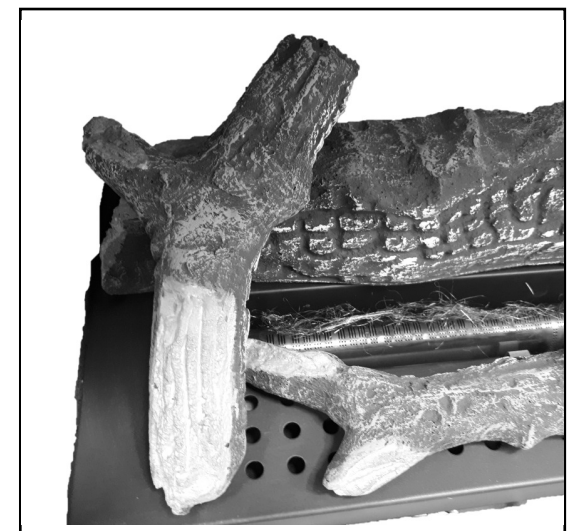

INSTALLER GUIDE

13.6. Place log '6' to the right of log '5' so that it is resting at the front in the recess in log '4' and to its rear on log '1'. Ensure that there is a gap between log '5' and log '6' as shown opposite.



13.7. Place log '7' to the right of log '6' so that it is resting at the front in the recess in log '4' and to its rear on log '1 & 2'. Ensure that there is a gap between log '6' and log '7' as shown opposite.



13.8. Place log '8' onto log '3' with one fork down on the notch. The rear of log '8' should rest on log '2' at the rear. Ensure there is a gap between log '3' and log '8' and log '7' as shown opposite.

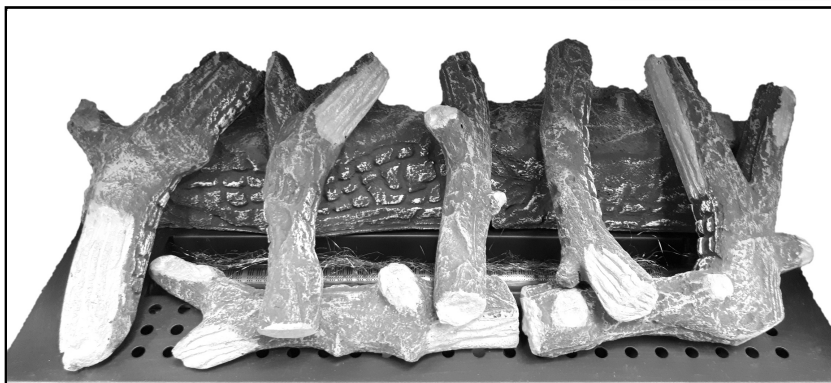
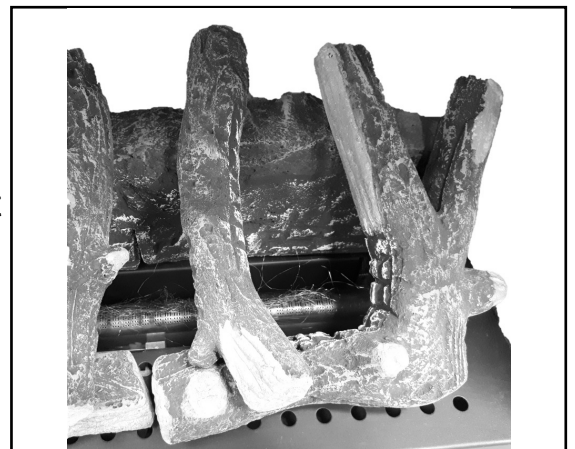

13.9. Full Log placement on as shown above.

Note: It is important that all logs are carefully placed to avoid any log movement during the use of this gas fire.

14. BURNER AND SUPPLY PIPE INSTALLATION

14.1 Burner installation.

1. Remove the 'Aeration checking' reminder label from the top of the burner.
2. Refit the burner unit to the convection box with the two screws removed previously.

NOTE: Do not tighten down fully these two screws as it can cause the burner tray to lift at the front interfering with later assembly. The screws only need to be tightened to prevent the tray from moving forward.

14.2 Supply pipe installation.

1. A nut and olive is provided for an 8mm-pipe inlet connection directly to the gas control. The isolating 'T' connector can be rotated to allow a connection from the rear. The 'T' connector includes a valve for isolating the gas supply.

The supply pipe must be rigid material. Flexible pipe must not be used. Connect the supply line to the appliance.

2. If closed, open the isolating valve at the inlet 'T' connector.
3. Turn on the gas supply and pressure check the installation pipework for gas soundness. In the United Kingdom (GB) check in accordance with the current edition of BS 6891. In the Republic of Ireland check in accordance with the current edition of IS 813 "Domestic Gas Installations".

Some burner operations can be checked at this stage. Checking now will mean that less disassembly will be required if any problems are found. ***A full check should still be made, however, after final installation. Only leave the burner alight long enough to confirm its operation.***

14.3 Burner checks.

14.3.1 Lighting the fire.

If closed, open the isolating 'T' connector valve.

– Push the slider handle to the LEFT as far as possible till the ignition position is reached, several sparks will occur between the electrode and pilot tip.

Hold in this position till the pilot flame has heated the thermocouple sufficiently to hold. Approx. 5 - 15 seconds.

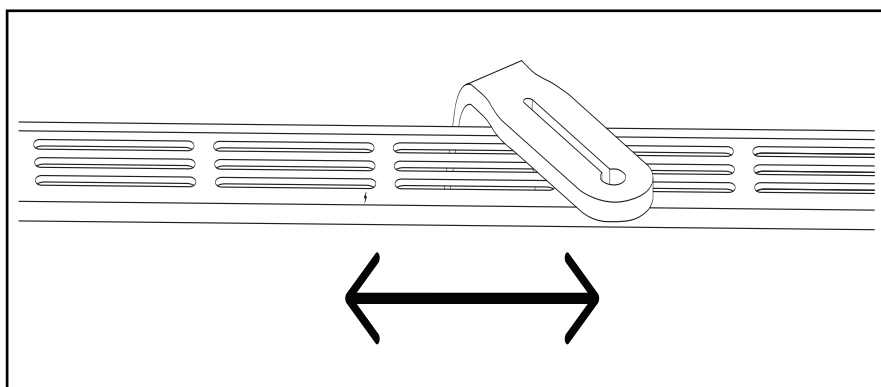

14.3.2 Adjusting flame height.

When the burner is operating step the slider handle to the RHS, increments will be felt as the slider moves giving you the following outputs;

Position 1 - After ignition/LOW

Position 2 - Moving slider handle one increment to RHS, burner is on MEDIUM.

Position 3 - Moving slider handle one more increment to the RHS, burner on HIGH

Position 4 - Moving the slider as far as possible to the RHS is OFF

Note: *There is no pilot only setting.*

14.3.3 Turning off.

To turn the fire off push the slider as far as possible to the RHS.

14.4 Check inlet pressure.

The appliance is pre-set to give the correct heat input at the inlet pressure shown in section 4 of this guide.

1. Ensure that the fire is OFF then fit a pressure gauge at the test point. The test point is on the inlet 'T' connector. Turn the fire ON and check the pressure with the appliance alight and set at maximum output.

2. After checking, turn off the appliance. Remove the pressure gauge and replace the test point sealing screw.

3. Test around the sealing screw for gas soundness with a suitable leak detection fluid.

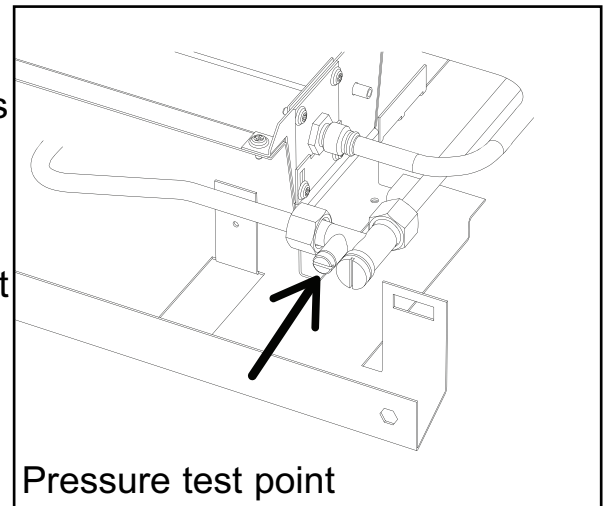

INSTALLER GUIDE

15. REASSEMBLE OF FIRE

The parts that were removed earlier now need to be refitted;

15.1 Place the bottom tray back into the convector box above the main burner assembly as before. Line up the tray with the screw holes in the inner convector box and using the screws removed earlier, secure it to the inner convector box.

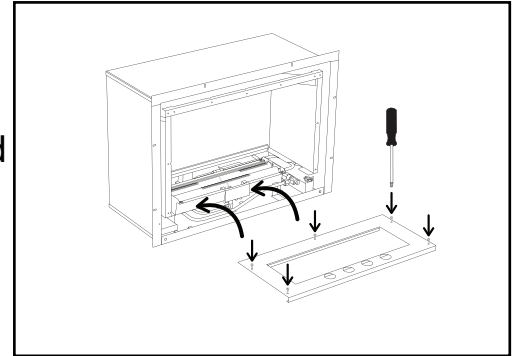

15.2 The top tray requires no screws it simply locates flat into position on top of the base tray.

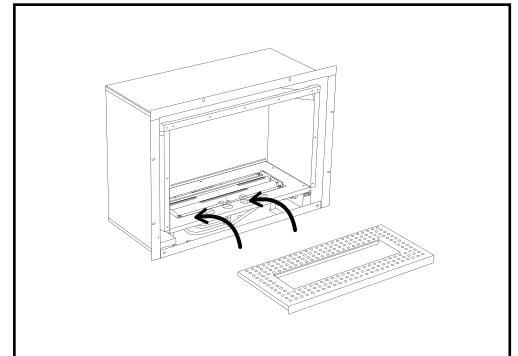

15.3 Install the Ember wool & Log set supplied
- Reference the log fitting guide Section 12 for details how the set must be placed.

15.4 Refit the window door panel, hook the top of the window door panel onto the top of the inner convector box. Lower the glass door till it covers fully the opening of the inner convector box. Screw back into place as before by hand the two M5 knurled screws in a clockwise direction just under the base of the window door frame. These screws only require to be hand tightened closed.

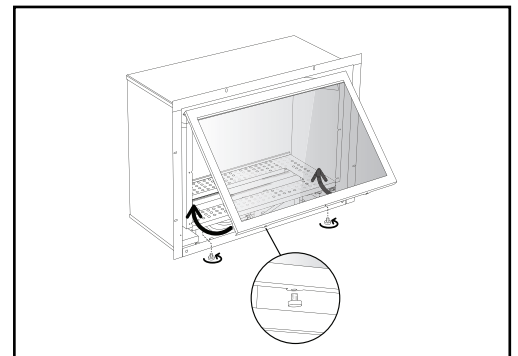

15.5 Replace the visual baffle, carefully slide back into place as before the visual baffle. Screw by hand the two M5 knurled screws in a clockwise direction to secure it.

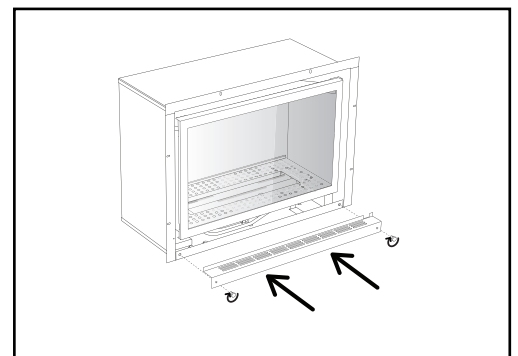

16.1 Check the burner operation.

Repeat the checks conducted in section 13.3.

Please note:

When first turned on from cold, the flames will appear predominantly blue.

When operating the fire for the first time, some vapours may be given off which could set off smoke alarms in the vicinity. These vapours are quite normal with new appliances. They are totally harmless and will disappear after a few hours use.

16.2 Check for spillage.

A spillage check must be made before leaving the installed appliance with the customer.

The spillage check must be conducted before fitting the trim.

1. Close all doors and windows in the room containing the appliance.
2. Light the appliance and set the control to its highest heat position.
3. Leave the appliance on for five minutes.
4. At the top of the heater are two openings. The upper opening has a tapered rear that has an opening of its own. The smoke match should be placed horizontally into this opening so that it touches the right hand side of the opening 100mm deep. It should pass the upper part of the opening by 25mm.

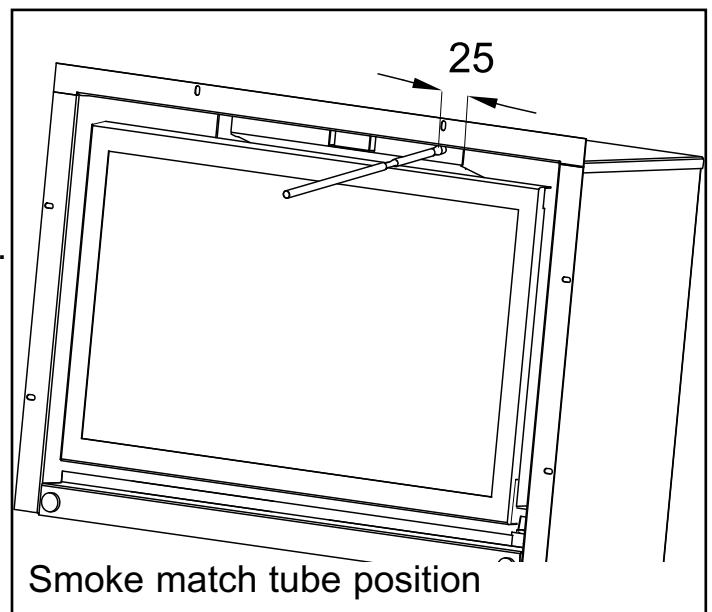

The installation is satisfactory if the smoke is drawn into the appliance.

If the smoke is not drawn into the appliance leave the appliance alight at the maximum setting for a further ten minutes and then repeat the test. If the smoke is still not drawn into the appliance inspect the sealing to the fireplace surround. If the sealing is satisfactory but the appliance is installed with the flue restrictor (See section 9, point 8) adjust the restrictor height, reseal the appliance and retest. If smoke is still not drawn into the appliance **disconnect the appliance and seek expert advice.**

5. If the above test is satisfactory open all internal connecting doors, hatches, etc. in the room. Keep all doors and windows that open to the outside of the building closed. Recheck for spillage as above. If an extractor fan is installed in the same room as the appliance or a connecting room, check that spillage does not occur with the fan

INSTALLER GUIDE

operating and all doors and other openings between the fan and the appliance open. If the smoke is drawn into the appliance, continue with the installation. If the test is not satisfactory **disconnect the appliance and advise the customer of the cause of failure.**

16.3 Flame supervision and spillage monitoring system.

This pilot unit includes a system that will automatically shut off the gas supply if the pilot flame goes out or if there is insufficient oxygen due to spillage or poor ventilation. **This monitoring system must not be adjusted, bypassed or put out of operation.**

This monitoring system or any of its parts must only be exchanged using Valor authorised parts.

17. TRIM INSTALLATION

Trim

Ensure the four magnets supplied on the rear of the trim are loaded one into each corner. Laid them flat against the inside corner surface of the trim. Offer the trim towards the fire, the trim secures with the magnets to the outside metal return on the outer convector box.

Push the trim tight up to the fire ensuring that the magnets are fully in contact and holding the trim in place.

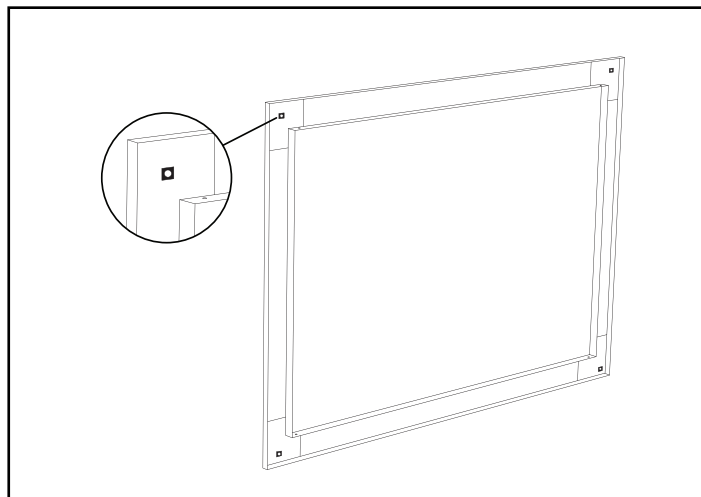

- 1. COMPLETE THE INFORMATION IN THE GAS FIRE COMMISSIONING CHECKLIST AND SERVICE RECORD OF THE OWNER GUIDE (See last pages of the OWNER guide).**
2. Visually inspect the appliance. Clean off any marks incurred during installation.
3. Advise the customer how to operate the appliance. Explain to the customer that the appliance has a flame failure & spillage monitoring system. Point out the explanation of this system shown in the owner guide under “Operating the fire”. Advise that if the fire goes out for any reason, wait at least three minutes before relighting. Stress that if the monitoring system repeatedly shuts off the fire, the appliance should be switched off and a specialist should be consulted.
4. Advise the customer that they should read their owner guide before operating the fire and always follow the advice in the section headed “Cleaning your fire”.
- 5. Stress that no extra ceramic fuel effect pieces or ember wool must be added over and above those supplied with the appliance and that any replacements must only be the authorised spares. Warn that ignoring this advice could cause incomplete clearance of the products of combustion with consequent health hazards. If you have not done so already; attach or place the ceramic fuel effect guide inside this guide.**
6. Advise the customer that the appliance will operate to its maximum potential if the flue is primed during the first 20 – 30 minutes of use. To do this, simply set the control to its highest setting. This will also burn off any carbon deposits that may have formed during previous use.
- 7. Emphasise that if the glass panel is broken or damaged, the fire should be turned off and not used until the window unit is refitted with an authorised replacement. The fire should not be used without the glass panel fitted.**
8. Advise the customer that when first turned on from cold, the flames will appear predominantly blue and it is normal for condensation to form on the rear of the glass panel. The condensation will disappear after a few minutes use.
9. If using the appliance for long periods it is beneficial to change between settings. This will also help to remove any carbon deposits that may form during use.
10. Recommend that the appliance should be serviced by a competent person annually.
11. If the appliance is in premises in the United Kingdom occupied by a tenant, point out that by law a landlord must have any gas appliance, flue and pipework which is situated in a tenant’s premises checked for safety at least every 12 months.
12. Advise that the fire may give off a slight odour while new. This is quite normal and it will disappear after a short period of use.
- 13. Inform the customer that the Serial number for the appliance is located on the information label, located to the side of the burner and also stuck into this manual**
14. Hand the literature packs with this guide to the customer.

- Always turn off the gas supply before commencing any servicing and allow the fire to cool completely (The appliance inlet ‘T’ connector incorporates an isolating valve).
- It is recommended that, at least once a year, the appliance is disconnected and the fireplace opening checked and cleared of any debris.
- This product uses fuel effect pieces, burner compartment walls and ceramic logs containing Refractory Ceramic Fibres (RCF), which are man-made vitreous silicate fibres. Excessive exposure to these materials may cause irritation to eyes, skin and respiratory tract. Consequently, it is important to take care when handling these articles to ensure that the release of dust is kept to a minimum. To ensure that the release of fibres from these RCF articles is kept to a minimum, during installation and servicing we recommend that you use a HEPA filtered vacuum to remove any dust and soot accumulated in and around the fire before and after working on the fire. When replacing these articles we recommend that the replaced items are not broken up, but are sealed within a heavy duty polythene bag, clearly labelled as RCF waste. RCF waste is classed as a stable, non-reactive hazardous waste and may be disposed at a landfill licensed to accept such waste. Protective clothing is not required when handling these articles, but we recommend you follow the normal hygiene rules of not smoking, eating or drinking in the work area and always wash your hands before eating or drinking.
- Check that the appliance is clean and that soot or debris is not blocking the gaps between the ceramic fuel effect pieces causing an imperfect flame.
- Check that soot or debris is not impairing the electrode spark or pilot burner.
- Check that soot or debris is not blocking any of the slots in the main burner.
- After servicing, make sure that the ceramic walls are replaced and the ceramic fuel effect pieces are replaced correctly as described in the installer and owner guide supplied with the ceramic fuel effect. The ceramic fuel effect guide may have been placed inside or attached to this guide.
- **Always test for gas soundness and spillage after servicing the appliance.**

19.1 To remove the trim.

1. The trim is held in place with four magnets one placed into each corner. Hold the lower outside edges of the trim and gently pull forward. With the corners released, lift the trim away from the convection box and clear.

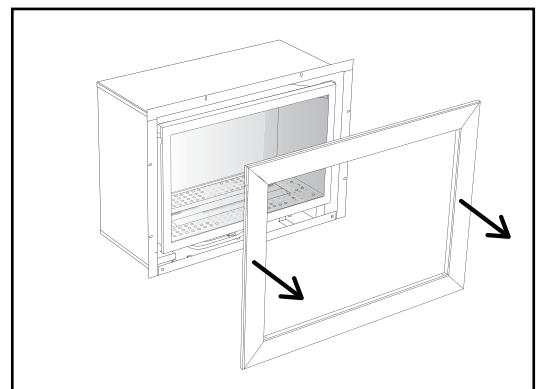

19.2 To remove the visual baffle.

1. Complete section 19.1
2. Remove the visual baffle, by unscrewing by hand the two M5 knurled screws in an anti clockwise direction. Keep these two screws save as they will be needed later. Carefully slide out the decorative trim and place carefully to one side.
3. Replace in the reverse order.

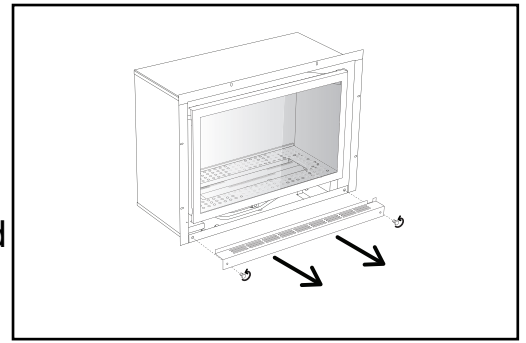

19.3 To remove the window door panel.

1. Complete section 19.2
2. Remove the glass door, by unscrewing by hand the two M5 knurled screws in an anti clockwise direction located just under the base of the door frame. Keep these two screws save as they will be needed later. Carefully pull out at the base then lift up and off the door and place carefully to one side.
4. Replace in the reverse order.

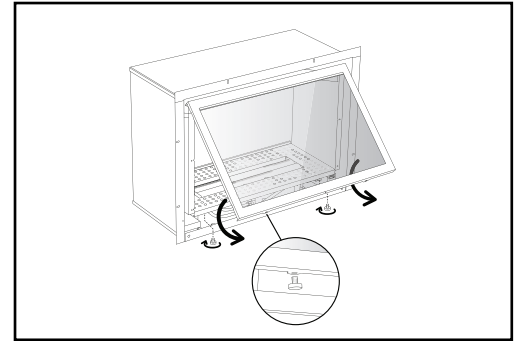

19.4 To remove the fuel effect and ember wool.

1. Complete sections 19.1 - 19.3
2. Remove the fuel effect in the reverse order to that shown for fitting in the ceramic guide. The ceramic fuel effect may cause staining / discolouration to decorative surfaces. It is therefore advisable to protect decorative surfaces. The ember wool is positioned across the burner carefully lift up all the steel wool and place carefully to one side. Refer to the installation instructions earlier regarding placing this ember wool back onto the burner.
3. Replace both in the reverse order.

19.5 To remove the top tray.

1. Complete sections 19.1 - 19.4
2. Lift out the Top tray and carefully place to one side. There are no screws holding this tray in place.
3. If glass liners have been fitted only, there will also be an additional filler top tray to the rear, lift this up also any place to the side. It is not held in place by any screws.

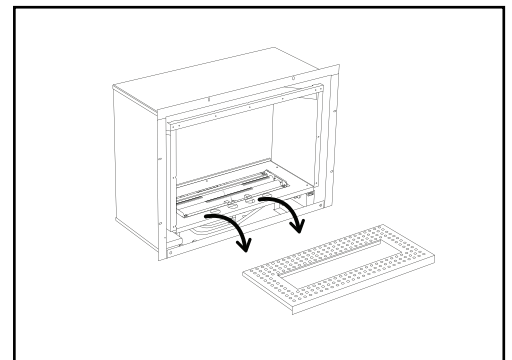

4. Replace in reverse order.

19.6 To remove the base tray.

1. Complete sections 19.1 - 19.5
2. Unscrew the base tray, then remove and place to one side carefully.
3. Replace in reverse order.

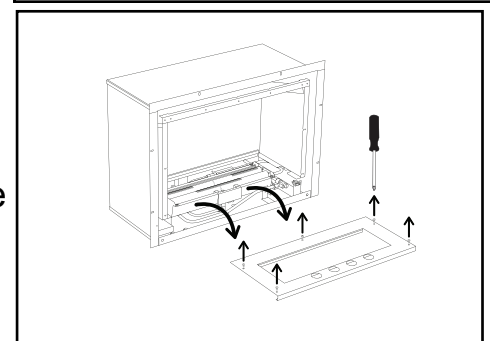

INSTALLER GUIDE

19.7 To remove the burner assembly and tray.

1. Complete section 19.1 - 19.6
2. Isolate the gas supply at the inlet isolating 'T' connector.
3. Support the inlet 'T' connector to avoid straining the pipework and disconnect the appliance from the inlet 'T' connector.
4. Unscrew the burner tray from the convection box by removing two locating screws.
5. Slide the burner tray unit clear of the convector box.
6. Replace in the reverse order.

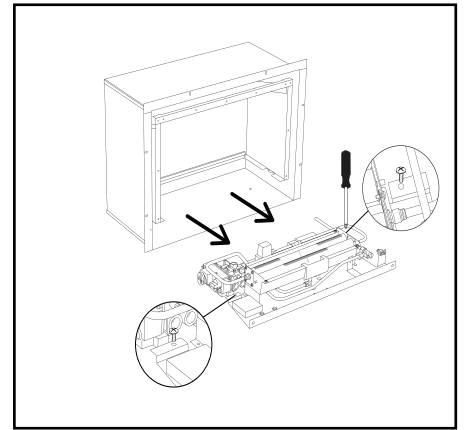

19.8 To access & remove the Inspection panel.

1. Complete sections 19.1 - 19.7
2. Unscrew the 4 screws, then remove and place the screws and panel to one side carefully.
3. Any inspection or cleaning of debris necessary can now be carried out.
3. Replace in reverse order, a flue flow test should be carried out at this stage. Refer to the relevant section of BS5440 Part 1 for this procedure.

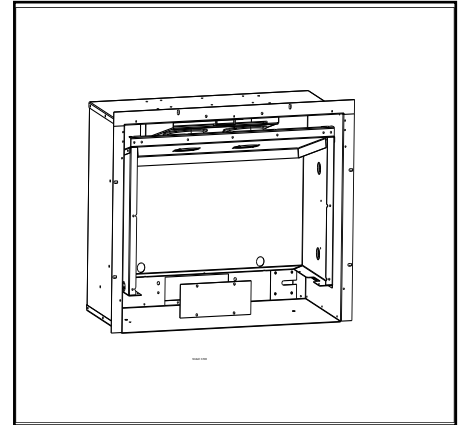

19.9 Checking the aeration setting of the burner.

1. The aeration shutter is factory set. It is important to ensure that the aeration setting is correct
2. The Modena burner use the aeration setting open at 4.5mm across the bottom 2 holes.
3. If the setting is not as shown, adjust the aeration setting(s). To do this loosen the two aeration shutter screws, slide the aeration shutter to the desired position and tighten the screws.

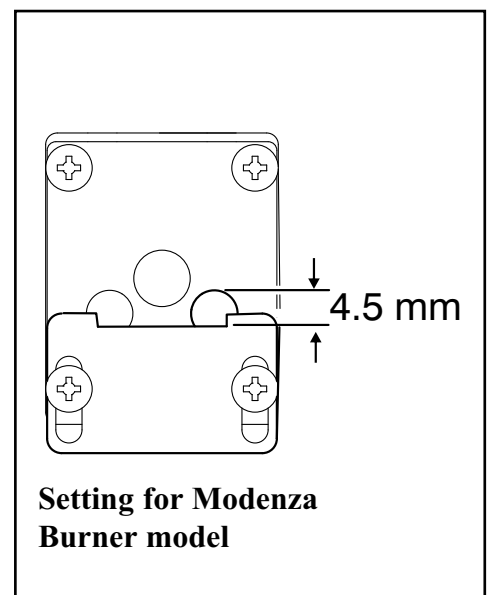

19.10 To remove the wall liners.

1. Complete section 18.1 - 18.7
2. The two side liners are secured in place by a metal tab bent up at 90 degrees. Using a flat head screw driver carefully bent these tabs back down horizontally to allow the liners to be moved.
3. There are finger holes in the inner convector box to allow easy access to gently push out the three wall liners. These are marked by a notch in the metal work behind which the hole can be reached using your fingers.
4. Start by removing the two side liners, gently guide the bottom of the liner wall out towards the inside of the convector box. Being careful not to rub off the rear liner. Lift the side walls clear of the convection box.
5. The rear liner(s) has two finger holes at the rear in the network frame to help access in removing the liner(s) out from the base. After locating the holes gently push out the liner(s) till flat inside the convector box then angle to remove being careful not to rub the edges off the inner convector box.
6. Replace in the reverse order.

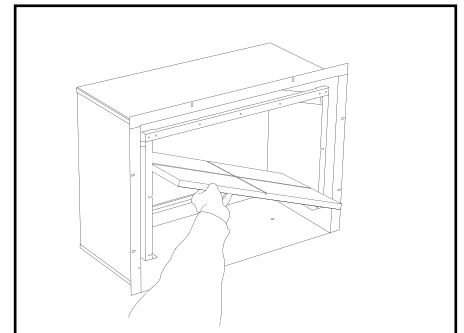
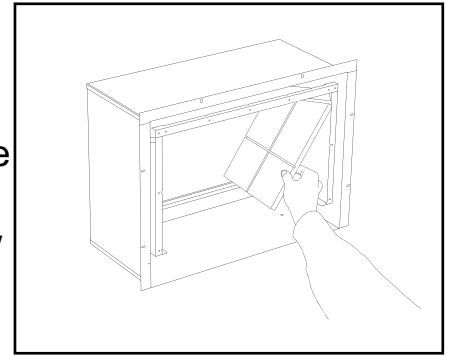

19.11 To remove the pilot unit.

1. Remove the burner assembly and tray (Refer to sections 18.5 - 18.7).
2. Detach the pilot pipe from the pilot unit.
3. Detach the electrode lead from the underside of the electrode tab.
4. Detach the thermocouple by unscrewing the thermocouple nut at the interrupter block for RC models and at the valve for FS models.
5. Remove the two screws from the pilot bracket.

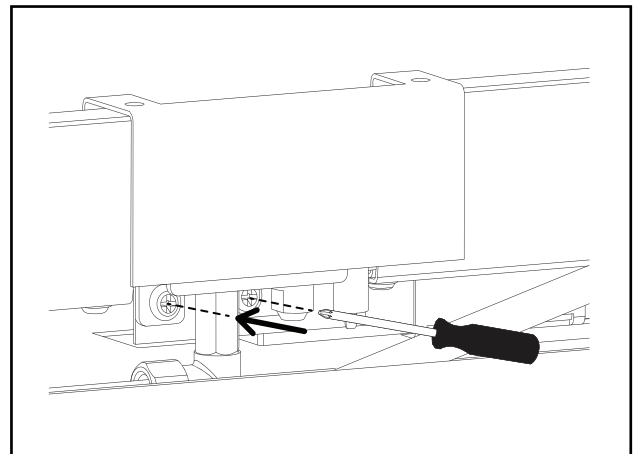

Note: it can be made easier to gain access to these two pilot bracket screws by unscrewing the two M4 x 8 machine screws taking the slider handle off and out of the way.

6. Remove the pilot bracket and pilot assembly.
7. Refit in the reverse order.

Note: The pilot unit is an atmosphere sensing device. It must be replaced as a whole assembly. Its individual components are not separately replaceable.

19.12 To remove the Teddington gas valve and switch.

1. Remove the burner assembly (See section 18.7).
2. If turning the burner tray upside down, ensure that the work surface is suitably protected. This will avoid damage to the work surface.
3. Remove the thermocouple by unscrewing the thermocouple nut at the end of the valve.
4. The ignition spark generator has 3 wire connections the top single wire comes from the pilot and the bottom side by side wires comes from the valve switch. All 3 wires should be carefully pull out straightly and disconnected.

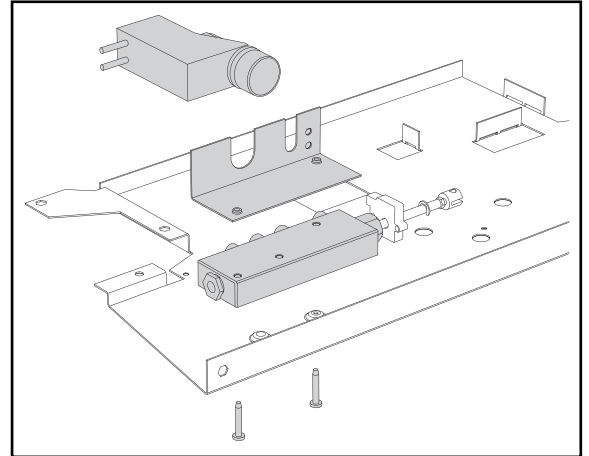

5. The ignition spark generator is then removed by first unscrewing the battery cap allowing easy access to the threaded washer behind, which secures the generator onto the metal bracket. Loosen this washer by hand and the generator will lift up and away.
6. Detach the pilot pipe from the gas valve.
7. Detach the inlet pipe.
8. Detach the front burner pipe.
9. Detach the rear burner pipe.
10. The valve is connected to the slider assembly by a screw in the connecting steel rod, remove this screw to disconnect from the slider arm.
11. Remove the two screws that retain the gas valve and top bracket from the base of the burner tray and lift the bracket and gas valve assembly clear.
11. Remove the gas valve.
12. Refit in the reverse order.

19.13 To replace the burner.

1. Remove the burner unit (See section 18.7).
2. Unscrew and remove the burner clamping plate from the upper right hand side of the burner. Remove all screws for ease.
3. Unscrew and remove the injector cover plate from underneath the burner.
4. Support the elbow injector and unscrew the injector nut.
5. Lift the right hand side of the burner, slide it to the right and lift clear
6. Refit in reverse order.

19.14 To remove the burner injector.

1. Remove the burner (See section 18.7).
2. Unscrew the injector from the burner.
3. Refit in the reverse order.

19.15 To remove the appliance from the fireplace.

- 1.** Follow steps 18.1 - 18.8.
- 2.** The inlet cover must be removed to allow the fire to be removed. Remove the screws holding the cover in place and any tape that has been added so that the hole in the rear of the fire is clear to allow the 'T' connector and pressure test point clearance to pass through.
- 3.** If the fire retention is as method 1 (See section 11.1 of this guide), remove the 6 screws.
If the fire retention is as method 2 (See section 11.2 of this guide), slacken the hexagonal adjusters on the cable retainers and unscrew the thumbscrews to release the cables.
- 4.** Remove the convector box from the fireplace.
- 5.** Refit as described in the relevant installation sections. Make sure gas soundness, sealing, spillage test and performance are satisfactory.

OWNER GUIDE

FOR WARRANTY, SERVICE AND BENCHMARK
INFORMATION SEE PAGES 53 TO 57

<u>Section</u>	<u>Page</u>
APPLIANCE DIMENSIONS	46
SAFETY	47 - 48
GAS CONSUMPTION	49
OPERATING YOUR FIRE	49
The Oxysafe flame sensing and flue blockage safety system.	49
Lighting the fire.	49
Adjusting the flame height.	50
To turn off using slider handle.	50
CLEANING YOUR FIRE	50
Trim, Metal and painted parts.	50
Removing and cleaning the window assembly.	50
Ceramic fuel effect log pieces and convector box compartment walls.	51
Burner.	51
MAINTENANCE	52
Battery replacement.	52
Spark ignition generator	52
Regular maintenance.	52
Replacement ceramics.	52
WARRANTY, SERVICE AND BENCHMARK	53 - 58
BENCHMARK COMMISSIONING CHECKLIST	56
BENCHMARK SERVICE RECORD	57
SERIAL NUMBER LABEL	58

This gas fire is designed to meet the most stringent quality, performance and safety requirements to provide you with many years' trouble-free service.

This guide aims to improve your understanding and appreciation of your gas fire by providing simple and informative instructions to ensure that you benefit from the excellent performance and features it has to offer.

OWNER GUIDE

APPLIANCE DIMENSIONS

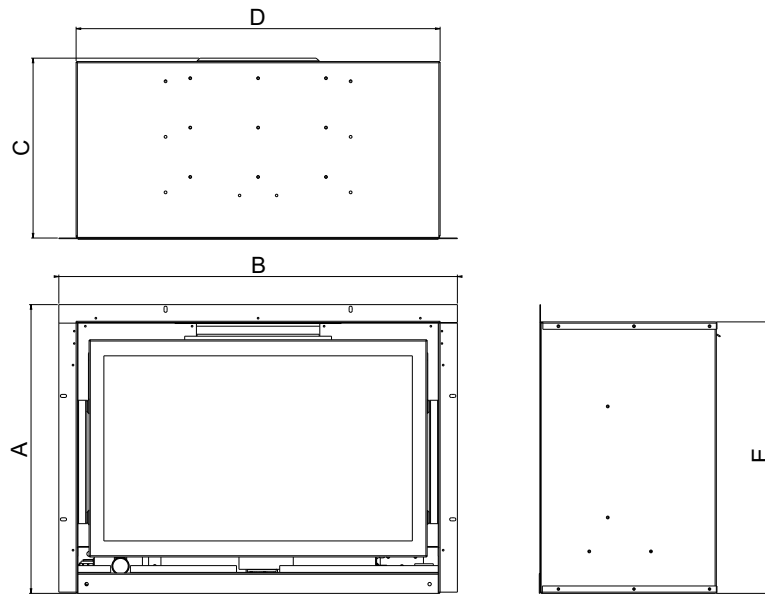

Dimension	Modenza
A	470 mm
B	646 mm
C	293 mm
D	596 mm
E	443 mm

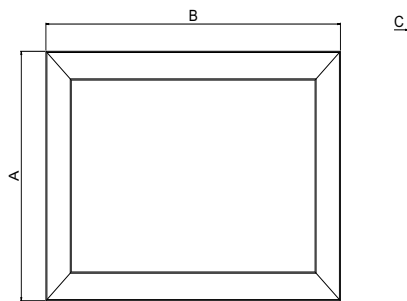

TRIM

Outside Dimensions stated.

Dimension	Trim
A	501 mm
B	677 mm
C	10 mm

IF YOU SMELL GAS

- **DON'T SMOKE.**
- **EXTINGUISH ALL NAKED FLAMES.**
- **DON'T TURN ELECTRICAL SWITCHES ON OR OFF.**
- **TURN OFF THE GAS SUPPLY AT THE METER OR TANK AS APPROPRIATE.**
- **OPEN DOORS AND WINDOWS TO GET RID OF THE GAS.**
- **IMMEDIATELY CALL THE GAS EMERGENCY SERVICE FROM A NEIGHBOURS PHONE - SEE YOUR LOCAL TELEPHONE DIRECTORY.**

Do have the fire installed by a competent person. In the United Kingdom, installation must be in accordance with the latest edition of the Gas Safety (installation & use) Regulations. In the Republic of Ireland, installation must be in accordance with all national and local regulations in force.

- Do** have the chimney swept prior to installation if it was previously used for solid fuel.
- Do** have the fire installed in accordance with the installation instructions.
- Do** wait three minutes before attempting to relight if the fire is switched off or the flames are extinguished for any reason. (Your fire is fitted with a safety device that will automatically shut off the gas supply to the fire if, for any reason, the flames go out).
- Do** get advice about the suitability of any wall covering near your fire. Soft wall coverings (e.g. embossed vinyl, etc.) which have a raised pattern are easily affected by heat. They may, therefore, scorch or become discoloured when close to a heating appliance. Please bear this in mind whenever you are considering redecorating.
- Do** provide a minimum side clearance of 300mm from the side of the appliance, not the trim. Please bear this in mind if ever you are considering altering the room.
- Do** provide a suitable guard that complies with BS 8423 for the protection of young children, the elderly, the infirm and pet animals.
- Do** provide the minimum height from the base of the fireplace opening to the underside of any shelf made from wood or other combustible materials. The appliance can be fitted to a purpose made proprietary class "O"-150°C surround. The hearth material must be at least 12mm thick. The periphery of the hearth (or fender) should be at least 50mm above floor level to discourage the placing of carpets or rugs over it. The surface of the hearth must be sufficiently flat to enable the bottom of the front surround and the bottom front cover to be aligned horizontally. Any excessive unevenness (uneven tiles, Cotswold stone, etc.) should be rectified. The appliance must not stand on combustible materials or carpets. Where no hearth is fitted.

OWNER GUIDE

Do ensure all combustable materials must be removed from the area shown in below diagram. The use of heat resistant plaster or board is recomended within the below shaded areas

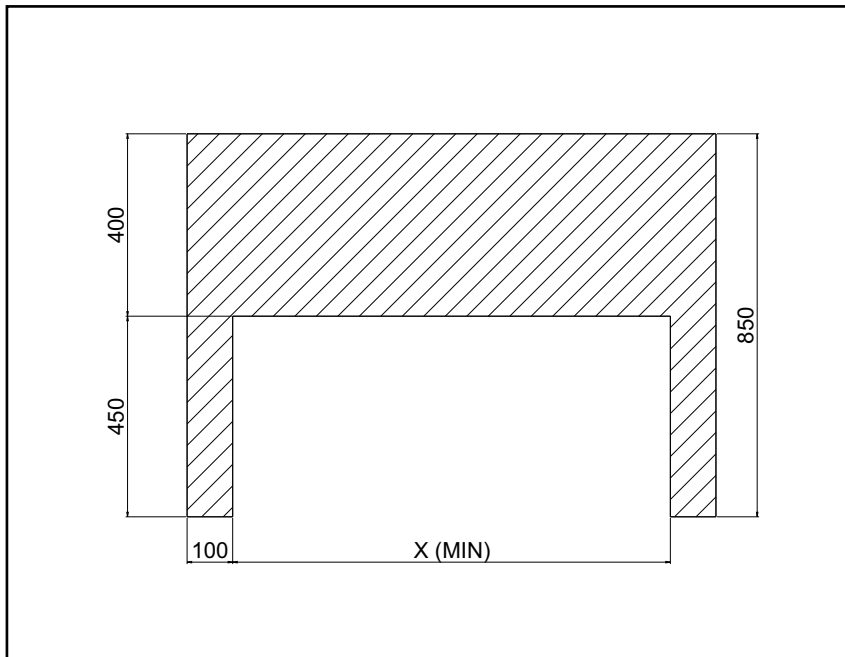

Model	Dimension X
Modenza	600 mm Min

Do ensure that a combustable shelf must be a minimum of 400mm above the top of the appliance. This is based on a 150mm deep shelf. For every extra 13mm of depth add 25mm above the 400mm from the top of the appliance, not the trim.

Don't hang clothing, towels or any other fabrics over the fire.

Don't add any ceramic fuel effect pieces to the burner. This could cause incomplete combustion and safety hazard.

Don't put paper or any other material on the fire.

Don't place any combustibile material (rugs, carpet, plastic tiles, etc.) on the hearth.

Don't attempt to clean or service the fire until it has been switched off and allowed to cool completely.

OWNER GUIDE

GAS CONSUMPTION

Natural Gas - Modena

HIGH	- NG input of;	5.6kw (Gross)
MEDIUM	- NG input of;	3.7kw (Gross)
Ignition/Min	- NG input of;	2.7kw (Gross)

OPERATING YOUR FIRE

PLEASE NOTE

When operating your fire for the first time, some vapours may be given off which may cause a slight odour and could possibly set off any smoke alarms in the immediate vicinity. These vapours are quite normal with new appliances. They are totally harmless and will disappear after a few hours use.

The Oxysafe flame sensing and flue blockage safety system.

For your safety, this appliance is fitted with a flue blockage safety device which will shut down the appliance in the event of abnormal flue conditions. ***This device is NOT a substitute for an independently mounted Carbon Monoxide detector.***

The device will also automatically shut off the gas supply to the fire if the pilot flame goes out due to lack of oxygen or for any other reason.

If this device starts to repeatedly shut off the gas, get expert advice.

This device incorporates a probe which senses that the heat from the pilot flame is correct. If this probe is cool, the device will prevent any gas flow unless the control knob is held in at the ignition position.

If, for any reason, the flames go out when the fire is hot or if the fire is turned off when hot, always ***wait at least three minutes before attempting to relight.***

Lighting the fire.

– Push the slider handle to the LEFT as far as possible till the ignition position is reached, several sparks will occur between the electrode and pilot tip.

Hold in this position till the pilot flame has heated the thermocouple sufficiently to hold. Approx. 5 - 15 seconds.

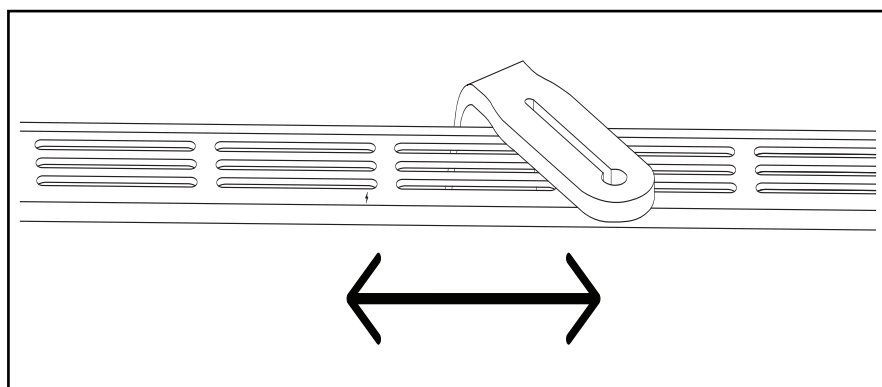

OWNER GUIDE

Adjusting flame height.

When the burner is operating step the slider handle to the RHS, increments will be felt as the slider moves giving you the following outputs;

Position 1 - After ignition/LOW

Position 2 - Moving slider handle one increment to RHS, burner is on MEDIUM.

Position 3 - Moving slider handle one more increment to the RHS, burner on HIGH

Position 4 - Moving the slider as far as possible to the RHS is OFF

Note: *There is no pilot only setting.*

Turning off.

To turn the fire off push the slider as far as possible to the RHS.

CLEANING YOUR FIRE

To maintain the high performance and quality finish of your fire please follow these guidelines:

- Before attempting to clean the fire, please remember to turn off the fire and wait for the appliance to cool completely. The fire will retain heat for some time before cleaning can begin.
- If any pieces of debris are found in the convector box, have the chimney inspected before further use.

Trim, Metal and painted parts.

- Clean the metal and painted parts with a slightly damp, lint free non-abrasive cloth and then dry.
- Do **not** use abrasive cleaners, as these will scratch the fire surface.

Removing and cleaning the window assembly.

Removal of the window assembly is only necessary if you wish to clean the rear of the window or access the ceramic components. The window assembly can be cleaned with a mild detergent and water. Glass cleaner can also be used. Any stains on the glass can be removed with a non-abrasive cleaner such as a ceramic hob cleaner. Never use abrasive cleaners. Clean the window carefully in accordance with the instructions supplied with the cleaner.

OWNER GUIDE

1. The window door panel is secured at the bottom with two hand tightened M5 knurled screws.

2. With both knurled screws removed, gently pull the base of the window panel forward. Hold the window panel base and lift upward until clear.

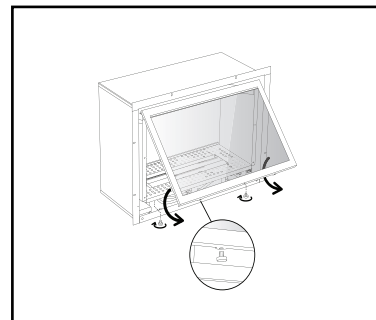

Ceramic fuel effect log pieces and convector box compartment walls.

To gain access to the ceramic components the window door assembly must be removed as in the previous section.

This product uses fuel effect pieces, burner compartment walls and ceramic pebbles containing Refractory Ceramic Fibres (RCF), which are man-made vitreous silicate fibres. Excessive exposure to this material may cause irritation to eyes, skin and respiratory tract. Consequently, it is important to take care when handling these articles to ensure that the release of dust is kept to a minimum.

– Light coatings of soot will usually be burnt off during the normal operation of the fire. Should any soot accumulation become excessive, the effected overlay log or ceramic fuel effect base should be removed from the fire for cleaning.

– Cleaning should be carried out in a well ventilated area or in the open air by gently brushing with the pieces held away from your face so that you avoid inhaling the dust.

– We do not recommend the use of a normal domestic vacuum cleaner which may blow dust back into the air.

– We suggest that you remove the ceramic fuel effect pieces in the reverse order to that shown in the ceramic fuel effect installer and owner guide.

– Once cleaned replace the log fuel effect as in ceramic fuel effect installer and owner guide.

Burner.

To gain access to the burner the window assembly, ceramic components and top tray must be removed as in the previous sections.

Remove any deposits of soot or other foreign matter from the surface of the burner with a dry soft brush. Be careful not to brush any particles into the open slots.

Remove any particles from the slots with a vacuum cleaner fitted with a soft brush attachment. **Do not poke wire, etc. into the slots in the burner.**

Battery replacement.

Please note: In order to ensure maximum battery life and optimal performance, we recommend that only 'Long Life' alkaline type replacement batteries are used.

Spark ignition generator

The spark ignition generator are battery powered (1.5-Volt). To replace the single 'AA' battery required it is not necessary to remove the visual baffle but you may do so if easier access required. At the front of the electronic spark generator there is a removable circular battery cover. Unscrew the cover in an anticlockwise direction.

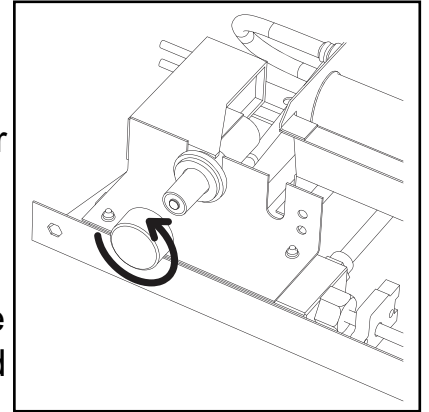

Remove any protective film from the new battery if applicable and place into the generator. The negative (-) terminal should go in first. The battery is marked with (+). Screw back on the cap.

Regular maintenance.

In order to achieve and maintain high levels of personal safety and performance efficiency, it is essential that the opening at the back of the fire and the flue are kept clear of any form of obstruction.

It is possible that deposits of mortar or soot could fall and accumulate causing the flue to be blocked or restricted and so preventing proper clearance of dangerous exhaust fumes.

In the United Kingdom it is the law that a landlord must have any gas appliance, flue and pipework which is situated in a tenant's premises checked for safety at least every twelve months by a competent person (GAS SAFE REGISTER operative). We recommend that all gas appliances and their flues, wherever situated, are checked annually.

The service engineer must complete the relevant Service Record on **Page 57** after each service.

Replacement ceramics / liners / ember wool.

If you wish to replace the ceramic log fuel effect / liners / ember wool, etc spare parts are available from our customer service team call the UK Helpline on **0844 879 35 88** or from the Republic of Ireland on **01 842 8222**.

Standard Warranty Terms & Conditions

The warranty is for 12 months subject to contract.

In the United Kingdom servicing can be carried out either by a **GDC** service operative or a **GAS SAFE REGISTER** operative. You must register your fire by calling our telephone registration line on **08444 810 214**.

This product should be serviced annually to optimise its safety, efficiency and performance. The GAS SAFE REGISTER service engineer must complete the relevant Service Record on the Benchmark Checklist after each service.

It is also a requirement of the warranty that the fire has an annual service (every 12 months) in accordance with the installation and servicing instructions.



Benchmark Checklist/Service Record

Please ensure that the installer has fully completed the Benchmark Checklist on the inside back pages of the installation instructions supplied with the product and that you have signed it to say that you have received a full and clear explanation of its operation. The installer is legally required to complete a commissioning checklist as a means of complying with the appropriate Building Regulations (England and Wales).

Installations carried out in England and Wales must be notified to Local Area Building Control either directly or through a Competent Persons Scheme. A Building Regulations Compliance Certificate will then be issued to the customer who should, on receipt, write the Notification Number on the Benchmark Checklist.

The filled in Benchmark Checklist/Service Record by the installer will be required in the event of any warranty (UK and Ireland installation).

After servicing, complete the relevant "Service Interval Record" section of the Benchmark Checklist located on the inside back pages of this document.

Our promise to you

If you experience a fault with your new fire, we aim to provide a safe and high quality repair service supported by our dedicated national network of highly skilled operatives.

If your installer can't resolve the problem for you, we will do everything we can to get an operative out to you as quickly as possible. Nothing in this warranty will affect your statutory rights.

-What you need to do if you experience a problem with the operation of the fire:

– You should always contact your installer first, because the cause of the fault may not be related to the fire.

– If your installer confirms that the fault is with the fire and they can't repair it, our friendly customer service team is on hand to help.

– Simply call our UK Helpline on **0844 879 35 88** or from the Republic of Ireland on **01 842 8222** for any general advice that you may need.

When calling the **Helpline**, it would be helpful if you could have the following information to hand:-

1. Fire serial number/barcode*
(Located on the appliance data label, also on this manual).
2. Date of installation*
3. Your installer name and address details*
4. Fire make and model number*
5. Annual Service record details*
6. Proof of purchase (if you do not have the fire serial number)

***Note: details 1 – 5 should be recorded as part of the Benchmark Checklist / Service record at the end of this guide.**

What this warranty covers

Free of charge repair or replacement of components found to be of faulty manufacture.

Free of charge replacement of the complete unit providing the failure is related to a manufacturing fault that cannot be repaired or is uneconomic to repair.

What this warranty does not cover

Repairs to fires which haven't been installed and commissioned properly and as set out in the installation instructions.

Faults caused by inadequate supply of gas or electricity (where applicable).

Reimbursement of any third party repair or replacement costs that we haven't been told about or agreed with you in advance.

Compensation or consequential losses (e.g. loss of earnings, business losses, stress and inconvenience) arising from a production breakdown, including repair delays caused by factors outside our reasonable control.

OWNER GUIDE

GAS FIRE COMMISSIONING CHECKLIST

This Commissioning Checklist is to be completed in full by the competent person who commissioned the gas fire as a means of demonstrating compliance with the appropriate Building Regulations and then handed to the customer to keep for future reference.

Failure to install and commission according to the manufacturer's instructions and complete this Benchmark Commissioning Checklist will invalidate the warranty. This does not affect the customer's statutory rights.

Customer name:	Telephone number:	
Address:		
Gas Fire make and model:		
Gas Fire serial number: <input type="text"/>		
Commissioned by (PRINT NAME):		Gas Safe register number:
Company name:		Telephone number:
Company address:		
		Commissioning date:
Building Regulations Notification Number (if applicable):		

Site Requirements	Yes	N/A
Was the chimney checked to ensure it only serves one flue/fire, has no obstructions and is continuous?		
Has any debris at the base of the chimney been removed?		
For brick chimney installations is there enough depth for 12 litres of debris, or precast flues 2 litres of debris? (see instructions for debris gap details)		
Have damper and register plates been removed or locked in the fully open position ensuring correct size of flue is maintained?		
If previously used for solid fuel has the chimney been thoroughly swept?		
If the chimney is pre-cast has the inside of the flue been checked for extruded cement / sealant which must be removed?		
Has the fire place been checked for under-floor air supply which must be sealed off?		
Has the chimney been inspected prior to fitting the gas fire to ensure that it is in good condition?		
Has the structure of the chimney been checked for leakage using a smoke pellet test? (See BS5440-1 for details).		
Ventilation		
Does the installation require any additional ventilation requirements as detailed in the manufacturer's instructions?		
Hearth Requirements- where fitted		
Is the hearth constructed from non -combustible material?		
Is the hearth a minimum of 12mm thick with a minimum floor to top surface of 50mm?(BS5871) or as per manufacturer's instructions?		
Is the hearth for open fronted fires a minimum of 760mm wide and has 300mm projecting from the fire opening (BS6871) or to manufacturer's instructions?		
Mounting height (where applicable) has the fire been installed to the correct mounting height- as per manufacturer's instructions?		
Firebox and Fuel Bed		
Has the fuel bed, coals, pebbles etc. been fitted to manufacturer's instructions?		
Gas Supply		
Has an isolation tap/restrictor inlet elbow been fitted for servicing?		
Has the gas supply been thoroughly purged prior to connection to remove any debris?		
Has a gas tightness test been completed prior to breaking into the gas supply and following completion of installation?(IGEM/UP/1B)		
Record burner gas pressure reading? If only the supply pressure is available a gas rate must be undertaken.(GSIUR REG26/9C)		
Record dynamic inlet gas pressure (working pressure) reading (all gas appliances running)		
Spillage test		
Installation passes smoke match test with any extractor fans turned on (see manufacturer's instructions)		
Installation		
Has the gas fire been installed and commissioned in accordance with manufacturer's instructions?		
Has the fire been installed with the correct clearance to combustible materials, as per manufacturer's instructions?		
The operation of the appliance and controls have been demonstrated to the customer including battery replacement where applicable?		
The manufacturer's literature, including Benchmark Checklist and Service record has been explained and left with the customer?		
Has the appliance been registered with the Local Authority as detailed on the Gas Safe web site and is a legal requirement and forms part of the warranty?		
Customer's Signature: (To confirm satisfactory demonstration and receipt of manufacturer's literature)	Commissioning Engineer's Signature:	

*All installations in England and Wales must be notified to be Local Authority Building Control (LABC) either directly or through a Persons Scheme. A Building Regulations Compliance Certificate will then be issued to the customer.



OWNER GUIDE

SERVICE RECORD

It is essential that your gas fire is serviced regularly and that the appropriate Service Interval Record is completed.

Service Provider

Before completing the appropriate Service Record below, please ensure you have carried out the service as described in the manufacturer's instructions. Always use the manufacturer's specified spare part when replacing controls.

SERVICE 01		Date:	SERVICE 02		Date:
Engineer name:			Engineer name:		
Company name:			Company name:		
Telephone No:			Telephone No:		
Gas safe register No:			Gas safe register No:		
Comments:			Comments:		
Signature			Signature		
SERVICE 03		Date:	SERVICE 04		Date:
Engineer name:			Engineer name:		
Company name:			Company name:		
Telephone No:			Telephone No:		
Gas safe register No:			Gas safe register No:		
Comments:			Comments:		
Signature			Signature		
SERVICE 05		Date:	SERVICE 06		Date:
Engineer name:			Engineer name:		
Company name:			Company name:		
Telephone No:			Telephone No:		
Gas safe register No:			Gas safe register No:		
Comments:			Comments:		
Signature			Signature		
SERVICE 07		Date:	SERVICE 08		Date:
Engineer name:			Engineer name:		
Company name:			Company name:		
Telephone No:			Telephone No:		
Gas safe register No:			Gas safe register No:		
Comments:			Comments:		
Signature			Signature		
SERVICE 09		Date:	SERVICE 10		Date:
Engineer name:			Engineer name:		
Company name:			Company name:		
Telephone No:			Telephone No:		
Gas safe register No:			Gas safe register No:		
Comments:			Comments:		
Signature			Signature		



A LABEL CONTAINING THE SERIAL NUMBER AND BARCODE MAY HAVE BEEN PLACED
INSIDE THIS BOX.

SERIAL NUMBER LABEL
TO BE AFFIXED HERE

